

COMPANY PROFILE



(Reg. No. 201907227C)

P-CON

BUILDING SURVEYORS PTE. LTD.



RICS

CHARTERED BUILDING SURVEYORS
英国皇家特许屋宇测量师



chartered association
of building engineers
英國特許建築工程師

*biz*SAFE₄



(Reg. No. 201907227C)

P-CON
BUILDING SURVEYORS PTE. LTD.



RICS
CHARTERED BUILDING SURVEYORS

INTRODUCTION

P-CON Building Surveyors Pte. Ltd. is a professional building surveyors firm providing building surveying and inspection services for all types of buildings and structures in Singapore and Southeast Asia countries.



P-CON Building Surveyors Pte. Ltd. was incorporated in March 2019. The directors of the company are Chartered Building Surveyors registered with the Royal Institution of Chartered Surveyors (RICS) UK, Chartered Building Engineers registered with the Chartered Association of Building Engineers (CABE) UK, and incorporated member of the Chartered Institute of Building (CIOB) UK.

RICS is a world leading professional body in the field of land, property, construction and infrastructure. CABE and CIOB are known as the professional bodies for those specializing in the building technology.

With our clear and concise reporting format and high level of service, we have successfully completed over 300 projects comprising residential, commercial, industrial properties and infrastructure throughout Singapore. Building strong and trustworthy working relationships has enabled P-CON Building Surveyors Pte. Ltd to quickly become the preferred building surveyor for prominent clients such as Knight Frank, Jones Lang LaSalle, CBRE, Sato Kogyo, SsangYong, Hock Lian Seng, CCECC, Chye Joo, Hwa Seng, Chan & Chan, Lum Chang, Samwoh, Eng Lam, Ed. Zublin AG, LC&T, Boustead, CPC, Woh Hup, Takenaka, Tiong Seng, Aik Leong, PBT and many more.

OUR SERVICES



- Pre-Construction Condition Survey & Post-Construction Condition Survey
- Project Management of Repair & Redecoration (R&R) Works
- Building Condition Survey/ Defects Survey
- Water Seepage Survey (including thermographic scanning, water ponding test, water spray test)
- Due Diligence Survey/ Pre-Purchase Building Survey
- Pre-Leasing Condition Survey
- Dilapidation Survey



(Reg. No. 201907227C)

P-CON
BUILDING SURVEYORS PTE. LTD.



RICS
CHARTERED BUILDING SURVEYORS

VISION

- To be the region's pre-eminent building surveyor of choice.

MISSION

- **Our Clients**

To deliver superior quality professional services to meet and exceed our Clients expectation.

- **Our People**

To empower our people towards personal and professional growth with continuous learning and development.

CORE VALUES

- **Integrity**

We promise to uphold our professional integrity and ethics, delivering professionalism in all we do.

- **Innovation**

We are passionate about seeking new ideas & technologies to be the pacemaker in the industry.

- **Culture**

We aim to be the benchmark organization in the industry; attracting, developing & enriching the right people who will deliver the best professional services.

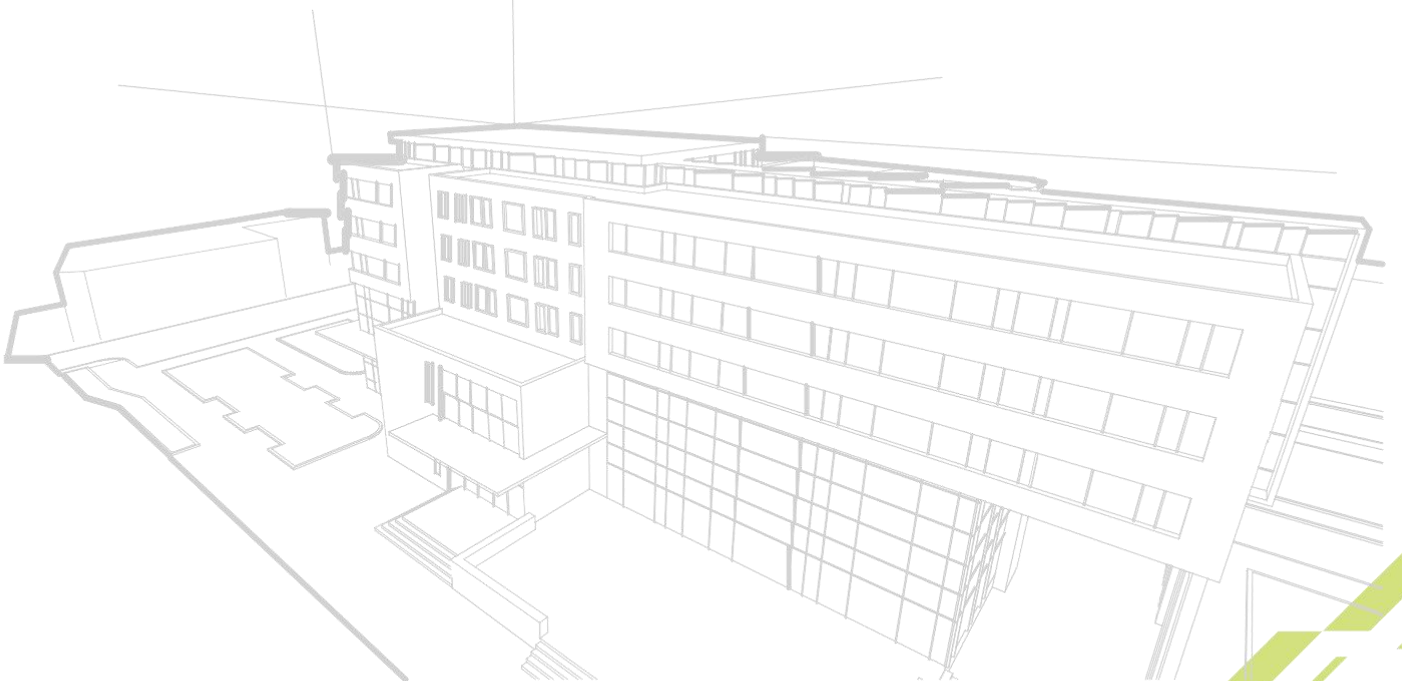



(Reg. No. 201907227C)

P-CON
BUILDING SURVEYORS PTE. LTD.



RICS
CHARTERED BUILDING SURVEYORS

THE MANAGEMENT TEAM



Surveyor Yap Yeong Chwan holds a BSc. (Hons) Building Surveying from University of Malaya, Malaysia. He is a Chartered Building Surveyor registered with the Royal Institution of Chartered Surveyors (RICS) UK, a Chartered Building Engineer registered with the Chartered Association of Building Engineers (CABE) UK, an incorporated member of the Chartered Institute of Building (CIOB) UK, and a Registered Member of the Royal Institution of Surveyors Malaysia (RISM).

After graduating from University of Malaya in 2001, he had spent 4 years working as a building surveyor at Building Appraisal Pte. Ltd. He is the founder and director of P-CON Building Surveyors Sdn. Bhd, the leading building surveying firm in Malaysia since Year 2008.

With a total of 23 years of experience in the building surveying industry in Singapore and Malaysia, he is an expert in giving advice on the matters of building condition (including defects inspections, investigations, rectifications, pathology & diagnosis), technical due diligence survey, construction impact to the surrounding areas, precautionary measures and being an expert witness for litigation and arbitration cases.

Over the 23 years, he has been actively involved as a consultant to provide professional advice for many projects in Singapore, Malaysia, Vietnam & Myanmar.

PRE-CONSTRUCTION CONDITION SURVEY

Projects in Singapore: -

LTA Projects

- Proposed New Depot Expansion With Associated Facilities To Existing Sengkang And Punggol LRT Depot At Sengkang East Avenue, Singapore 545051 (Sengkang Planning Area).
- Contract 810C - Design, Construction And Completion Of Sengkang Punggol Light Rapid Transit (Lrt) Depot Expansion With Associated Facilities.
- Contract N102 - Design And Construction Of North South Corridor (Tunnel) Between Victoria Street And Kampong Java Road.
- CR113 - Design And Construction Of Serangoon North Station And Tunnels.
- CR115 - Design And Construction Of Tavistock Station And Tunnels.
- DE170 - Construction Of Tengah Vehicular Interchange At KJE.
- Contract CR103 - Design And Construction Of Aviation Park Station And Tunnels.

- Contract J112 - Design And Construction Of Jurong Hill Station, Jurong Pier Station And Viaduct For Jurong Region Line.
- Contract J113 - Design And Construction Of Nanyang Gateway Station, Nanyang Crescent Station And Viaduct For Jurong Region Line.
- Contract 190 - Design And Construction Of Integrated Train Testing Centre.
- Contract N106 - Design And Construction Of North South Corridor (Tunnel Between Novena Rise And Toa Payoh Rise).
- Contract T315 - Addition And Alteration Works To Existing Tanah Merah Station And Viaducts.
- DE159 - Roadworks At Lim Chu Kang Area.



(Reg. No. 201907227C)

P-CON
BUILDING SURVEYORS PTE. LTD.



RICS
CHARTERED BUILDING SURVEYORS

- Contract 1406: Implementation Of Noise Barriers At Rail Viaduct Phase 3.
- DE143 - Commuter And Road Infrastructure Works In Pasir Ris And Loyang, Flora Road And Flora Drive.
- CR1079 - Sewer And Water Diversion Works (Package B).
- TR315 - Proposed Silver Zone Scheme.
- Proposed Road Widening And Related Works At Serangoon North Ave 1 (Serangoon Planning Area).

PUB Projects

- Proposed Twin 1800mm Diameter Water Pipelines From Bishan Road To Woodleigh Park.
- Proposed 900mm To 1600mm Diameter Industrial Water Pipelines Along Tembusu Avenue And Jurong Island Highway - Contract 4
- Construction Of Link Sewers For The Dtss Phase 2 Project - Schedule Iii Contract 2 (Old Choa Chu Kang Road / Jalan Bahar) (Balance Works).
- Tuas Water Reclamation Plant (TWRP) - Contract 3A - Industrial Liquids Modules Civil And Building Services Works.
- Seraya Firewater Network Line Project.
- Improvement To PA Camp And Parbury Outlet Drains (From East Coast Parkway To The Sea).
- Provision Of Worker Dormitories For DTSS Phase 2 Project @ Penjuru Road.
- Contract 4A - Biosolids and Digesters For The Tuas Water Reclamation Plant.
- Proposed 1600mm Diameter Water Pipeline Along Still Road South, Still Road And Jalan Eunus.

HDB Projects

- HDB 38 Jalan Bahagia
- Proposed Public Housing Development At Jalan Rajah.
- HDB - (A) Construction Of Sin Ming Street (Part 1); (B) Trunk Sewer Diversion At Sin Ming Estate.
- (Project CP) Bukit Batok Neighbourhood 4 Contract 27 - Proposed New Erection Of Public Housing Development At Bukit Batok West Avenue 8 / Bukit Batok Road (Bukit Batok Planning Area).
- (Yishun N5 C12) Proposed Public Housing Development At Yishun Ave 1.
- Construction Of Bus Bays, Signalized Traffic Junction Cum U-Turn, Cycling Path And Linkways At Jalan Boon Lay / Boon Lay Way.
- Construction Of Covered Linkways (Batch 60) At Bishan East - Thomson Road Proposed Construction Of DOP At Block 313 Shunfu Road.
- HDB Improvement Works To Surface Car Park (SCP) Batch 80.
- Proposed 3 Blocks Of Residential Building & 1 Block Of Car Park At Jurong West St. 93 Upp Jurong Rd N9C20.
- Construction Works For A 5/6-Storey Multi Storey Car Park At Hougang Street 21.

JTC Projects

- Construction Of Road, Drain And Sewer At Tukang - Phase 2A.
- Proposed 9-Storey Light Industrial Development At Woodlands Avenue 4 & 9 (JTC Innovation Precinct) (Woodlands Planning Area).

Others

- Changi Airport (aircraft hangars 1-3); Suntec City (5 blocks); Far East Plaza; Hong Leong Building; Expo MRT Station (MRT tunnels), etc.

Projects in Malaysia: -

- Expressways/ Railways/ Sewerage/ Pipelines/ MRT & LRT Projects (e.g. PLUS/ ECRL/ WCE/ DUKE/ DASH, etc.)
- Mega Projects (e.g. Tun Razak Exchange/ Forest City Johor/ KL ECO City, etc.)
- Others (e.g. Singapore High Commission in KL - by Obayashi Corp; hospitals; airports; factories, etc.)

Project in Myanmar: -

- Landmark project, Yangon - by SPA Project Management Ltd, Singapore.



(Reg. No. 201907227C)

P-CON
BUILDING SURVEYORS PTE. LTD.



RICS
CHARTERED BUILDING SURVEYORS

DUE DILIGENCE SURVEY

Projects in Singapore: -

- Sembawang Kimtrans Logistic Centre; CG Aerospace Warehouse; Volex Building; Woollerton Park Condominium, etc.

Projects in Malaysia: -

- CP Tower; Wisma Consplant 1 & 2; Plaza Mont' Kiara; Club Med Cherating Beach Resort, etc.

BUILDING CONDITION/ DEFECTS SURVEY

Projects in Singapore: -

- Wellington Circle (7 HDB blocks); Lotus at Joo Chiat; Hong Leong Tower; NOL Building; HOYA Building; Lincoln Modern/ The Atria/ Chiltern Park/ Floravale/ Northvale/ Regentville/ Maysprings Condominiums, etc.

Projects in Malaysia: -

- Asian International Arbitration Centre (AIAC/ KLRCA) Sulaiman Building; EDC-UUM Hotel; Citibank Tower; TGV Cinemas; British Ambassador's Residence (KL); Factory of Valves Components Ltd, etc.

Project in Vietnam: -

- The Lien Westlake Resort Hotel (Currently known as InterContinental Hanoi Westlake), Nghi Tam Village, Hanoi.

EXPERT WITNESS IN LEGAL PROCEEDINGS

- Contractor (Client: Anas Construction) vs Takaful Insurance - construction damage dispute in Penang.
- Buyer (Client) vs Developer (Ivory Properties) - building defects claim in Penang.
- Piling Contractor (Client: Long Kee Piling) vs Building Owner - construction damage claim in Johor.
- Developer (Client: Monday-Off Development) vs Main Contractor - construction dispute in Kuala Lumpur.
- Contractor (Client: KMU/ EISCON) vs Building Owner - construction damage claim in Kuala Lumpur.

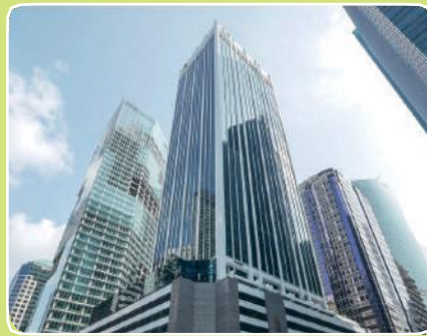



(Reg. No. 201907227C)

P-CON
BUILDING SURVEYORS PTE. LTD.



RICS
CHARTERED BUILDING SURVEYORS



Surveyor Teng Chiou Siong
Director

Surveyor Teng Chiou Siong (Bryan) holds a B.Sc. (Hons) Building Surveying from University of Malaya, Malaysia. He is a Chartered Building Engineer registered with the Chartered Association of Building Engineers (CABE) UK, and a Member of the Royal Institution of Surveyors Malaysia (RISM).

After graduating from University of Malaya in 2001, he had spent 4 years working as a building surveyor at Building Appraisal Pte. Ltd. He is the founder and director of P-CON Building Surveyors Sdn. Bhd, the leading building surveying firm in Malaysia since Year 2008.

He has over 23 years of experience in the building surveying field in Singapore and Malaysia, involved in building surveying works such as pre & post construction condition survey, pre-purchase/ due diligence survey, dilapidation survey, building condition survey, building defect pathology and diagnosis, detects investigation and rectification works, water seepage survey, maintenance advice, landlord/ tenancy matters, survey on property damaged due to adjoining construction works, etc.

PRE-CONSTRUCTION CONDITION SURVEY

Projects in Singapore: -

LTA Projects

- Proposed New Depot Expansion With Associated Facilities To Existing Sengkang And Punggol LRT Depot At Sengkang East Avenue, Singapore 545051 (Sengkang Planning Area).
- Contract 810C - Design, Construction And Completion Of Sengkang Punggol Light Rapid Transit (Lrt) Depot Expansion With Associated Facilities.
- Contract N102 - Design And Construction Of North South Corridor (Tunnel) Between Victoria Street And Kampong Java Road.
- CR113 - Design And Construction Of Serangoon North Station And Tunnels.
- CR115 - Design And Construction Of Tavistock Station And Tunnels.
- DE170 - Construction Of Tengah Vehicular Interchange At KJE.
- Contract CR103 - Design And Construction Of Aviation Park Station And Tunnels.
- Contract J112 - Design And Construction Of Jurong Hill Station, Jurong Pier Station And Viaduct For Jurong Region Line.
- Contract J113 - Design And Construction Of Nanyang Gateway Station, Nanyang Crescent Station And Viaduct For Jurong Region Line.

PUB Projects

- Proposed Twin 1800mm Diameter Water Pipelines From Bishan Road To Woodleigh Park.
- Proposed 900mm To 1600mm Diameter Industrial Water Pipelines Along Tembusu Avenue And Jurong Island Highway - Contract 4
- Construction Of Link Sewers For The Dtss Phase 2 Project - Schedule Iii Contract 2 (Old Choa Chu Kang Road / Jalan Bahar) (Balance Works).
- Tuas Water Reclamation Plant (TWRP) - Contract 3A - Industrial Liquids Modules Civil And Building Services Works.
- Seraya Firewater Network Line Project.

HDB Projects

- HDB 38 Jalan Bahagia
- Proposed Public Housing Development At Jalan Rajah.
- HDB - (A) Construction Of Sin Ming Street (Part 1); (B) Trunk Sewer Diversion At Sin Ming Estate.
- (Project CP) Bukit Batok Neighbourhood 4 Contract 27 - Proposed New Erection Of Public Housing Development At Bukit Batok West Avenue 8 / Bukit Batok Road (Bukit Batok Planning Area).
- (Yishun N5 C12) Proposed Public Housing Development At Yishun Ave 1.

JTC Projects

- Construction Of Road, Drain And Sewer At Tukang - Phase 2A.



(Reg. No. 201907227C)

P-CON
BUILDING SURVEYORS PTE. LTD.



CHARTERED BUILDING SURVEYORS

Others

- Changi Airport (aircraft hangars 1-3); Suntec City (5 blocks); Far East Plaza; Hong Leong Building; Expo MRT Station (MRT tunnels), etc.

Projects in Malaysia: -

- Infrastructures/ Railways/ Expressway (e.g. MRT/ LRT/ Monorail/ BRT/ ECRL/ Electrified Double Track projects; highways projects such as Senai - Pasir Gudang - Desaru Expressway, Kajang - Seremban Expressway; Besraya Eastern Extension of Sungai Besi Expressway; PLUS Highway; EKVE; WCE; SUKE; DASH, etc.)
- Hospital projects (e.g. Subang Jaya Medical Centre; Kangar Hospital; Taiping Hospital; Bentong Hospital; UIAM Teaching Hospital; Hospital Putrajaya; Pantai Hospital Kuala Lumpur; Columbia Hospital Jalan Tebrau; KPJ Hospital Penang; Hospital Pantai Melaka, etc.)
- Mixed developments (e.g. Lido Boulevard; Media City Kuala Lumpur Development; KL ECO CITY; Tun Razak Exchange; Coronation Square Johor, etc.)

DUE DILIGENCE SURVEY

Projects in Singapore: -

- Hyflux Building; Volex Building; Da Vinci Building; Cluny Hill Bungalow; Nan Wah Building, etc.

Projects in Malaysia: -

- CP Tower; Wisma Consplant 1 & 2; Plaza Mont' Kiara; Club Med Cherating Beach Resort; Kolej Yayasan Saad; St. Joseph's Institution International School; Asia Pacific International School, etc.

BUILDING CONDITION/ DEFECTS SURVEY

Projects in Singapore: -

- Westcove; Eastvale; UMCi Building; Factory of I.C Equipment Pte Ltd; Singapore MIT Alliance (SMA) Office; Gendale Park; Sunny Metal & Engineering Pte Ltd; Parc Vista/ Kew Green/ Avalon/ Le Hill/ Maysprings/ Hillview Green Condominiums, etc.



(Reg. No. 201907227C)

P-CON
BUILDING SURVEYORS PTE. LTD.



RICS
CHARTERED BUILDING SURVEYORS



Surveyor Lim Swee Meng
Director

Surveyor Lim Swee Meng holds a B.Sc. (Hons) Building Surveying and M.Sc. Project Management from University of Malaya, Malaysia. He is a Chartered Building Surveyor registered with the Royal Institution of Chartered Surveyors (RICS) UK and a Fellow of The Royal Institution of Surveyors Malaysia (RISM).

He worked with Developer firms, Pamir Development Sdn. Bhd and Sunrise Berhad in Malaysia after his graduation from Year 2006 to 2008, involved in supervision and coordinating of construction works, project handover, technical inspection and rectification works, etc.

He relocated his career to Singapore in 2009 and began working as a Building Surveyor at Building Appraisal Pte. Ltd. During his 13 years tenure, he has been involved in project management of MCST Repair & Redecoration (R&R) project, maintenance management inspection, pre-construction condition survey, building defects inspection, building quality control (CONQUAS), external façade (curtain walling & cladding) inspection, property damage and building condition survey.

He has more than 18 years of extensive experience in the building surveying and project management and has participated in the following projects.

PROJECT MANAGEMENT OF REPAIR & REDECORATION (R&R) PROJECT

- Baywater Condominium (MCST PN. 3163), Beauty World Centre (MCST PN. 2121), Bukit View Condo (MCST PN. 2121), Cascadale Condominium (MCST PN. 2071), Changi Court (MCST PN. 2276), Changi Green (MCST PN. 2298);
- Coronation Road 27A, Hume Park II (MCST PN. 2213), Innovation Place (MCST PN. 2678), Landridge Condominium (MCST PN. 1959), Mid View@Bt Batok (MCST PN. 2688), One North Residences (MCST PN. 3466);
- Orange Grove Residences (MCST PN. 3554), Peshurst Place, No. 3, Pinevale Condominium (MCST PN. 2492), Ripple Bay Condominium (MCST PN. 4412), Scotts 28 (MCST PN. 2471), Simsville Condominium (MCST PN. 2412);
- Spanish Village (MCST PN. 1358), The Atria@Meyer (MCST PN. 2185), The Esparis (MCST PN. 3015), The Glyndebourne (MCST PN. 4180), The Hillford Condominium (MCST PN. 4485), The Rivervale (MCST PN. 2586);
- The Tropica Condominium (MCST PN. 2596), The Windsor (MCST PN. 1463), Toh Guan Centre (MCST PN. 2746), UB. One Building (MCST PN. 3740).





(Reg. No. 201907227C)

P-CON
BUILDING SURVEYORS PTE. LTD.



RICS
CHARTERED BUILDING SURVEYORS

WATER SEEPAGE SURVEY

- 1 Pandan Valley, #05-104 Camellia Terrace, 38 Sungai Kadut St 2 (Sen Wan Timber), 69 Telok Kurau, 7 Gambas Cres #05-14 Ark@Gambas, Ah Soo Garden, Amber Road #21-04, Amber Residences, Anglo Chinese School;
- Bedok Court Blk 299 #05-12, Bedok Residences Block 30 #15-48, Bedok Residences Block 30 #15-48, Braddel Hill Block 10A #18-03, Chestervale Condo #18-02 & #19-02, Clementi Park Block 135 #06-18 & #07-18;
- Clementi Park Block 137 #01-21 & 02-21, Crystal Tower, Delight Court, 16 Lor 33 Geylang #03-03, Emerald Park, Farrer Drive No. 79, Sommerville #05-03, Fortune Park #03-08 & #04-08, Good Wood Residences Block 263 #12-13;
- Grand Mercure Roxy Hotel, Great World Serviced Apartment, Haig Road No. 161, Taipan Regency, Henderson Building #01-06, Aamor, Hillbrooks Condo Blk 90 #01-07, Hillview Ave 136, Merawood #07-06;
- Hoamgar@2 Bayfront Avenue, Marina Bay Sands#01-70, Jalan Kuras No. 32, Jalan Lim Tai See, Ventura Heights No. 71C, Jalan Mutiara No. 11, #11-03 Mutiara View, Jewel @ Changi, The Suite, Jurong Penjuru Dormitory;
- Kim Sia Court Blk 1 #02-05, Marina Bay MRT Station, Melville Park, Simei St 1 Blk 20 #01-10, Merawoods #01-04 & #02-04, Neptune Court Blk 8 #22-29, Northvale Condominium, Nouvelle Park, Yio Chu Kang Road #04-09;
- Novena Court 16A & 16B, Palm Spring, Palm Spring, Pandan Valley #08-201, Pandan Valley #08-201, Parc Oasis, Parklane Shopping Mall, Robinson No. 112 Building, Singapore Swimming Club, Singapore Swimming Club;
- Spring Grove #14-01, St Francis Court #02-03, St Francis Court #02-03, Suntec City H&M, Tanglin View Condominium, The Coast, Sentosa Cove, The Inspira Condominium, Le Mercier, The Palisades, The Sound #04-05;
- Thomson Grand Unit No. 31, 53, 57, 67, 71 & 73, Thomson Grand Unit No. 59, Thomson Grand Unit No. 59, Verde View No. 15 and No. 45, Verde View No. 7 & No. 21.

BUILDING CONDITION/ DEFECTS SURVEY

- Marine Blue Condominium; Parc Centros; Thomson V two; Thomson Grand; The Panorama; Tampines Industrial Drive; Skies Miltonia; DUO Residences #03-09; 14 Pebble Lane, 11C Rosyth Road; 178 Bishan St 13; 484 Admiralty Link; Lake Grande; Sol Acres; Marina One Residences; The Marq on Paterson Hill; The Peak, etc.
- Paragon Din Tai Fung; Varsity Park, West Coast Road; Binchang Walk No. 3; Caribbean Blk 36 #04-81; Changi Court; City Square Residences (CDL); Dunsfold Drive 45C; Dunsfold Drive 43A; Dunsfold Drive 43D; Jalan Merdu No. 32; Metropolitan Condominium, etc.
- San Lian Deng Temple Admiralty Street No. 18; The Summit; California Fitness, Bugis Club; Casa Merah; Eunos Techpark; Jalan Chelagi No. 34; Mimosa Road 2C; Residences at Emerald Hill; Lakeshore Condominium; Livia (CDL); St Martin's Drive No. 27; The Metropolitan Condominium, etc.
- Grand Mercure Roxy Hotel; Leedon Park No. 12, 12A & 12B; NV Residences; Puay Hee Avenue No. 73; Temasek Polytechnic Sports Complex; The Estuary at Yishun Ave 1; Tree House, 37 Jalan Sedap; 43 Oxley Road; Aljunied Industrial Complex Block 623 & 625; Bugis Junction Tower, etc.
- Maria Avenue No. 8; Ocean Financial Centre; Pearl Island, Sentosa; Stamford America International School; Urban Resort Condominium; Tuas Lane No. 2 Industrial Building; Amara Hotel 100AM; Jalan Bumbong No. 43; Jalan Eunos No. 84, etc.
- Marina Bay Sands #01-03,04,05 DC Comics Super Heroes; Residence at Emerald Hill, 119 Emerald Hill Rd #03-02; The Shore Residences, Amber Road; Bedok Residences; Bishan Block 103; Central Boulevard; Hotel Jen; MUH@31 Media Circle; The Daily Farm, etc.
- Tree House@Chestnut Drive; 38 Sungai Kadut St 2 (Sen Wan Timber); Marine Blue Condominium; Parc Centros; Parc Centros Block 90 Unit 1523; Thomson V two; The Panorama; Tampines Industrial Drive; Skies Miltonia; Pavilion Square; 5 Chancery Lane, etc.
- 48 & 48A Changi South; Marina Bay Sand Casino; 133 Tai Keng Gardens; KLIA Heineman Duty Free Shop; The Trillium; The Visionaire, etc.



(Reg. No. 201907227C)

P-CON
BUILDING SURVEYORS PTE. LTD.



RICS
CHARTERED BUILDING SURVEYORS

PRE & POST CONSTRUCTION CONDITION SURVEY

- Ardmore Park; Bendemeer Primary School; Jalan Kembang Melati No. 12; Jalan Tukang; TradeHub 21; Windsor Park Road No. 8; Gambas Crescent; Insead International Business Institution; Sengkang (new primary school); Tembeling Road No. 275; Insead Campus; etc.

DUE DILIGENCE SURVEY

- 108 Middle Road; OUE downtown Commercial and Serviced Apartment; FM Global Centre; Cecil Street No. 158; Chevron House; Church Street, Capital Square; Robinson Road No. 108; Robinson Point; Park Hotel at Clarke Quay; Crowne Plaza Hotel at Changi Airport etc.
- Straits Trading Building; 108 Middle Road; OUE downtown Commercial and Serviced Apartment; etc.

ALLEGED DEFECTS SURVEY

- Cornwall Gardens No. 22A; Atelier Villas No. 53; Atelier Villas, Yio Chu Kang; Axis @ Siglap; Casa Merah Condominium; Atelier Villas; Casabella; No. 07-06 Delfi Orchard; The Seaview Place; Vida, Peck Hay Road #08-06 (Far East); Bedok Court Blk 299 #05-12, Jalan Redop No. 2; etc.
- Resort World Sentosa Wave Pool; Hillview Ave 136, Merawood #07-06; Jalan Sajak Nos. 49 & 49A; Spottiswoode Park #05-06; Jalan Limau Purut No. 58; Lorong L, Telok Kurau Road No. 153; Central Boulevard; etc.

PROPERTY DAMAGED SURVEY

- Jalan Chengkek No. 61; Bodmin Drive No. 44; Jalan Rama Rama #26-06; Lorong Marican No. 59A; Jalan Seaview, No. 61; Lorong 24 Geylang No. 9C; Mayflower Lane No. 32; The Central; etc.

FIRE SAFETY SURVEY

- People's Park Complex; Simsville Block 8; etc.

LEGAL PROCEEDINGS & EXPERT WITNESS

- Leedon park three (3) bungalow #12, #12A, #12B condition survey (Legal case); Mount Faber Lodge (Expert witness), etc.





(Reg. No. 201907227C)

P-CON
BUILDING SURVEYORS PTE. LTD.



CHARTERED BUILDING SURVEYORS



Surveyor Asha Balakrishnan
Director

Surveyor Asha Balakrishnan holds a diploma in Quantity Surveying from University of Technology Malaysia and a BSc. (Hons) Building Surveying from University of Malaya in Malaysia.

She is a Chartered Building Surveyor registered with the Royal Institution of Chartered Surveyors (RICS) UK, a Chartered Building Engineer registered with the Chartered Association of Building Engineers (CABE) UK and a Registered Member of The Royal Institution of Surveyors Malaysia (RISM).

After graduation, she was employed by Talam Corporation Berhad (Developer) as Project Executive. During her employment, she was involved in Defects Audit, Dilapidation Surveys, assist in Plan Vetting, Quality Spot-Checks for all stages in construction, Landscape and Infrastructure Inspections and participated in Certificate of Practical Completion (CPC) and Certificate of Fitness (CF) Inspections.

In 2002, she joined Vertitech (M) Sdn. Bhd. as Building Surveyor. During her 12 years tenure, she has been involved in Dilapidation Survey, Periodical Inspection, Condition/ Engineering Assessment, Appraisal of Structures, Fire Damage Assessment, Testing and Monitoring Works, Administrative Law and Building Regulations (Pre-Contract), and Building Contracts.

She joined P-CON Malaysia in 2014 as the Operation Manager to oversee the overall operations of the project department. With a strong background in forensic engineering, Sr. Asha has been designated as the Project Director since January 2019 to spearhead the Building/ Structural Condition Survey and Due Diligence division. She has more than 20 years of extensive experience in the construction industry and has participated in major projects such as: -

PRE-CONSTRUCTION CONDITION SURVEY

Projects in Singapore: -

LTA Projects

- Contract 190 - Design And Construction Of Integrated Train Testing Centre.
- Contract N106 - Design And Construction Of North South Corridor (Tunnel Between Novena Rise And Toa Payoh Rise).
- Contract T315 - Addition And Alteration Works To Existing Tanah Merah Station And Viaducts.
- DE159 - Roadworks At Lim Chu Kang Area.
- Contract 1406: Implementation Of Noise Barriers At Rail Viaduct Phase 3.
- DE143 - Commuter And Road Infrastructure Works In Pasir Ris And Loyang, Flora Road And Flora Drive.
- CR1079 - Sewer And Water Diversion Works (Package B).
- TR315 - Proposed Silver Zone Scheme.
- Proposed Road Widening And Related Works At Serangoon North Ave 1 (Serangoon Planning Area).

PUB Projects

- Improvement To PA Camp And Parbury Outlet Drains (From East Coast Parkway To The Sea).
- Provision Of Worker Dormitories For DTSS Phase 2 Project @ Penjuru Road.
- Contract 4A - Biosolids and Digesters For The Tuas Water Reclamation Plant.
- Proposed 1600mm Diameter Water Pipeline Along Still Road South, Still Road And Jalan Eunus.



(Reg. No. 201907227C)

P-CON
BUILDING SURVEYORS PTE. LTD.



RICS
CHARTERED BUILDING SURVEYORS

HDB Projects

- Construction Of Bus Bays, Signalized Traffic Junction Cum U-Turn, Cycling Path And Linkways At Jalan Boon Lay / Boon Lay Way.
- Construction Of Covered Linkways (Batch 60) At Bishan East - Thomson Road Proposed Construction Of DOP At Block 313 Shunfu Road.
- HDB Improvement Works To Surface Car Park (SCP) Batch 80.
- Proposed 3 Blocks Of Residential Building & 1 Block Of Car Park At Jurong West St. 93 Upp Jurong Rd N9C20.
- Construction Works For A 5/6-Storey Multi Storey Car Park At Hougang Street 21.

JTC Projects

- Proposed 9-Storey Light Industrial Development At Woodlands Avenue 4 & 9 (JTC Innovation Precinct) (Woodlands Planning Area).

Projects in Malaysia: -

- Sewerage project for the River of life project, Jinjang - Kepong, Kuala Lumpur, Malaysia.
- DUKE Expressway Phase 3 Setiawangsa - Pantai Expressway (SPE), Malaysia.
- Mass Rapid Transit (MRT) Project: Sungai Buloh - Kajang (Line 1), Package V1, V4 & V7, Malaysia.
- The semi-detached houses for the proposed 6 interchanges along LDP (Interchange No. 2, PJS7/PJS9), Sunway, Petaling Jaya, Malaysia.
- Package 3 - the proposed construction and completion part of Projek Lebuhraya Kemuning - Shah Alam (LKSA), highway stretch from Section 24 at Jalan 24/13 Shah Alam to interchange at Federal Highway Route 2 in Shah Alam, Selangor, Malaysia.
- Mass Rapid Transit (MRT) Project: Sungai Buloh - Serdang - Putrajaya (SSP Line 2), Malaysia and more.

INDEPENDENT CONDITION SURVEY

- Citibank branches at Kuala Lumpur, Selangor, Melaka, Sabah, Johor and Pulau Pinang, Malaysia.
- The existing suspended ceiling systems for TGV Cinemas (branches in Kuala Lumpur, Selangor, Perak & Negeri Sembilan), Malaysia.
- Condition Survey to the existing architectural dome structures of KL Sentral Station, Kuala Lumpur, Malaysia.
- Condition survey of the existing pre-war buildings for OCBC Bank at Logan Road, Krian Road, Irving Road, Macalister Road and Lebuh Pantai, 10300 Penang, Malaysia.
- A Holiday Resort (300 Guest Rooms) at Cherating Beach, Kuantan, Pahang, Malaysia.

INDEPENDENT CONDITION/ ENGINEERING ASSESSMENT

- Condition assessment & testing works to the Spanco Corporate office on Lot PT2, Jalna Perusahaan 2, Mukim Batu, Gombak, Selangor, Malaysia.
- Proposed engineering and condition assessment to the existing abandoned Airport Mall on Lot 10297, Kg. Jaya Setia, Berakas, Negara Brunei Darussalam.
- Condition assessment to the Cold Storage room at the MAS Catering Building, Kuala Lumpur International Airport.
- Structural investigation works to the basement concrete slabs at the Australian High Commission, Jalan Yap Kwan Seng, Kuala Lumpur, Malaysia.
- Condition assessment and testing works of the existing underground R.C. Culvert (Tunnel) of Tuanku Jaafar Power Station, Port Dickson, Negeri Sembilan, Malaysia.



(Reg. No. 201907227C)

P-CON
BUILDING SURVEYORS PTE. LTD.



RICS
CHARTERED BUILDING SURVEYORS

PERIODICAL INSPECTION

- Periodical inspection to the existing Citibank Tower, Jalan Ampang, Kuala Lumpur, Malaysia in accordance to the 'Street, Drainage and Building Act 1974' (Act A903).
- Periodical inspection to the existing 30-storey Public Bank Tower at No. 6, Jalan Sultan Sulaiman, 50000 Kuala Lumpur, Malaysia in accordance to the 'Street, Drainage and Building Act 1974' (Act A903).
- Periodical inspection to the existing 20-storey Perkeso Tower at No. 281, Jalan Ampang, 50450 Kuala Lumpur in accordance to the 'Street, Drainage and Building Act 1974' (Act A903).

DUE-DILIGENCE AND M&E CONDITION SURVEY

- The existing Kolej Yayasan Saad, Jalan Kolej Yayasan Saad, 75350 Ayer Keroh, Melaka, Malaysia.
- The existing St. Joseph's Institution International School, Tropicana Indah, Petaling Jaya, Selangor, Malaysia.
- The existing Asia Pacific International School at No. 1, Persiaran A, Off Jalan Persiaran Lapangan Terbang Subang 47200 Subang, Selangor Darul Ehsan.
- The existing Lumileds Plant 2, No. 3, Lintang Bayan Lepas Industrial Park at Bayan Lepas, Penang, Malaysia.
- A private higher learning institution in Johor Bahru, Johor, Malaysia.
- A 32-storey Office Tower (GFA: 514,796 sq ft) at Iskandar Johor, Malaysia.
- A private school (GFA: 349,321 sq ft) in Melaka, Malaysia.



(Reg. No. 201907227C)

P-CON
BUILDING SURVEYORS PTE. LTD.



RICS
CHARTERED BUILDING SURVEYORS

OUR EXPERTISE

- **Pre-Construction Condition Survey & Post-Construction Condition Survey**

We prepare a professional report which provides clients with the most accurate records of the existing condition of the buildings and structures adjoining to the proposed construction site before and/or after the commencement of the construction works. The report will assist the developers, contractors, as well as building owners to avoid dispute in the event of a claim for damage by property owners.

- **Project Management of Repair & Redecoration (R&R) Works**

To guarantee that the R&R project is completed on time, within budget, and in accordance with the standard of industry best practice, it is crucial that a qualified Chartered Building Surveyor supervise and manage the R&R Works. Our clients include Management Corporation Strata Title (MCST), REITs, Commercial, industrial & Residential Property Owners, etc.

- **Building Condition Survey/ Building Defects Survey**

An **IMPORTANT ASSESSMENT** on the physical condition of a building in particular, the building structure, fabrics and components, finishes, M&E operation systems and safety. The survey would advise on enhancing the performance and life span of a property.

There may already be a routine maintenance schedule in place, however it is advisable to conduct a Building Condition Survey to address the deficiencies in the building as a whole for better cost effective measures.

- **Water Seepage Survey**

Our expert team goes beyond diagnosis to deliver tailored solutions, often enhanced by thermographic scanning, water ponding test and water spray test to accurately address water seepage and leakage concerns. This proactive approach helps prevent unnecessary expenses and the inconvenience of extensive repairs.

- **Due Diligence Survey/ Pre-Purchase Building Survey**

A Technical Due Diligence Survey is a **KEY RISK MANAGEMENT TOOL** in property acquisition and property investment for local and international property buyers. Our report will be a powerful tool in decision making for buyers and negotiation with the seller. The report includes factors that must be considered before investing in a property such as the condition of the building and structures, M&E systems, fabrics and components, finishes, services and safety requirements.

- **Pre-Leasing Condition Survey**

The report provides an accurate record for pre-leasing and/ or post-leasing agreements by recording the original condition of the property. The survey report will be able to assist the building owner and/or the tenants shall the event of a claim for damage arise. The written and photographed documentation on the pre-leasing condition of the property will be used as a comparison for the post-leasing condition survey.

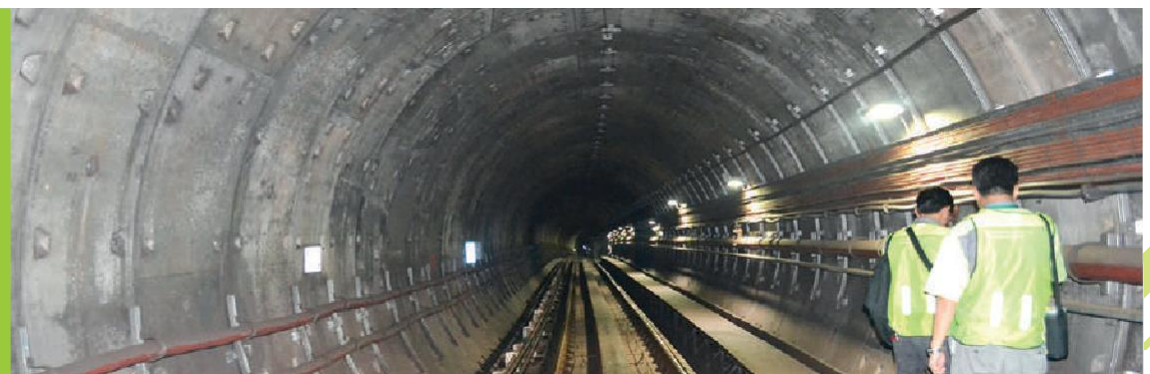



(Reg. No. 201907227C)

P-CON
BUILDING SURVEYORS PTE. LTD.



CHARTERED BUILDING SURVEYORS



(Reg.No.201907227C)

P-CON BUILDING SURVEYORS PTE. LTD.

Website: www.p-consurvey.com.sg

111 North Bridge Road, #21-01 Peninsula Plaza, Singapore 179098.

Tel: +65 6389 1777

H/p: +65 9710 3966 (Mr. Bryan Teng)

Fax: +65 6507 4488

E-mail: admin@p-consurvey.com.sg



SERVICES

- Project Management of Repair & Redecoration (R&R) Works
- Pre & Post Construction Condition Survey
- Due Diligence Survey / Pre-Purchase Building Survey
- Building Condition/ Defects Survey
- Pre-Leasing Condition Survey
- Water Seepage Survey
- Dilapidation Survey



(Reg. No. 201907227C)

P-CON BUILDING SURVEYORS PTE. LTD.

111 North Bridge Road, #21-01 Peninsula Plaza, Singapore 179098.

T: +65 6389 1777 M: +65 9710 3966 F: +65 6507 4488 E: admin@p-consurvey.com.sg

W: www.p-consurvey.com.sg

TRACK RECORD

S/N	Project Title	Description of Works	Commencement Date	Completion Date	Client
Repair & Redecoration (R&R) Projects					
1.	Project Management Services For Repair, Repainting, Water Proofing Works And Improvement Works at The Summit.	Project Manager of R&R Works	21/05/2024	Ongoing	MCST Plan no. 1788 MA: Melana International Pte Ltd
2.	Project Management Services For Repair, Repainting, Water Proofing Works And Improvement Works at Spanish Village.	Project Manager of R&R Works	09/10/2023	Ongoing	MCST Plan no. 1358 MA: Knight Frank Singapore
3.	Project Management Services For Repairs And Repainting Works To Beauty World Centre And Bukit View Condominium.	Project Manager of R&R Works	25/03/2023	Ongoing	MCST Plan no. 2121 MA: Chambers Property Management Services Pte Ltd
Water Seepage Survey					
4.	The Suspended Ceiling At Level 3 & Level 4 Immunos Building (Biopolis)-6200sqm.	Water Seepage Survey	22/11/2024	Ongoing	Immunos Building (Biopolis)
5.	10 Jalan Ilmu Singapore 292873.	Water Seepage Survey	22/10/2024	Ongoing	Sharon Galistan
6.	Basement Car Park (Double Slab Areas Only) At Parc Rosewood.	Water Seepage Survey	16/08/2024	Ongoing	MCST Plan no. 4122 MA: ONESG Holding Pte Ltd
7.	Basement Car Park and Level 1 At The Octagon	Water Seepage Survey	31/01/2024	Ongoing	MCST Plan no. 1521 MA: CBRE Singapore
8.	The Penthouses At 111 Emerald Hill, Singapore.	Water Seepage Survey	30/08/2023	Ongoing	MCST Plan no. 3774 MA: Jones Lang Lasalle Property Consultants Pte Ltd
Building Condition Survey					
9.	Building Condition Survey Acquisition Of Industrial Building (16 Pandan Road, Singapore).	Building Condition Survey	03/05/2024	Ongoing	Jones Lang LaSalle Property Consultants Pte. Ltd.

S/N	Project Title	Description of Works	Commencement Date	Completion Date	Client
LTA Projects					
10.	Proposed New Depot Expansion With Associated Facilities To Existing Sengkang And Punggol Lrt Depot On Lot 01398m(Pt), 02462w(Pt), 02127l(Pt) & 03140p(Pt) Mk21 At Sengkang East Avenue, Singapore 545051 (Sengkang Planning Area).	Pre-Construction Condition Survey	11/04/2023	24/05/2023	Sato Kogyo (S) Pte. Ltd.
11.	Contract 810c – Design, Construction And Completion Of Sengkang Punggol Light Rapid Transit (Lrt) Depot Expansion With Associated Facilities.	Pre-Construction Condition Survey	17/05/2022	25/11/2022	Sato Kogyo (S) Pte. Ltd.
12.	Contract N102 – Design And Construction Of North South Corridor (Tunnel) Between Victoria Street And Kampong Java Road.	Pre-Construction Condition Survey	14/04/2022	24/05/2022	SsangYong - Wai Fong Joint Venture
13.	CR113 – Design And Construction Of Serangoon North Station And Tunnels.	Pre-Construction Condition Survey	12/04/2022	13/06/2024	Hock Lian Seng Infrastructure Pte. Ltd.
14.	CR115 - Design And Construction Of Tavistock Station And Tunnels.	Pre-Construction Condition Survey	22/03/2022	Ongoing	Sato Kogyo (S) Pte. Ltd.
15.	DE170 – Construction Of Tengah Vehicular Interchange At Kje.	Pre-Construction Condition Survey	14/12/2021	22/08/2022	Chye Joo Construction Pte. Ltd.
16.	Contract CR103 – Design And Construction Of Aviation Park Station And Tunnels.	Pre-Construction Condition Survey	01/12/2021	28/07/2023	Hock Lian Seng Infrastructure Pte. Ltd.
17.	Contract J112 - Design And Construction Of Jurong Hill Station, Jurong Pier Station And Viaduct For Jurong Region Line.	Pre-Construction Condition Survey	14/06/2021	03/12/2021	CCECC Singapore Pte. Ltd.
18.	Contract J113 – Design And Construction Of Nanyang Gateway Station, Nanyang Crescent Station And Viaduct For Jurong Region Line.	Pre-Construction Condition Survey	05/06/2021	01/05/2023	Hwa Seng Builder Pte. Ltd.
19.	Contract 190 – Design And Construction Of Integrated Train Testing Centre.	Pre-Construction Condition Survey	30/12/2020	29/03/2021	GS Engineering and Construction Corp
20.	Contract N106 – Design And Construction Of North South Corridor (Tunnel Between Novena Rise And Toa Payoh Rise.	Pre-Construction Condition Survey	30/12/2020	05/03/2021	Chan & Chan Engineering Pte. Ltd.

S/N	Project Title	Description of Works	Commencement Date	Completion Date	Client
21.	Contract T315 - Addition And Alteration Works To Existing Tanah Merah Station And Viaducts.	Pre-Construction Condition Survey	03/11/2020	19/11/2020	Lum Chang Building Contractors Pte. Ltd.
22.	DE159 - Roadworks At Lim Chu Kang Area.	Pre-Construction Condition Survey	27/07/2020	01/07/2021	Samwoh Corporation Pte. Ltd.
23.	Contract 1406: Implementation Of Noise Barriers At Rail Viaduct Phase 3.	Pre-Construction Condition Survey	06/01/2020	22/02/2021	PBT Engineering Pte. Ltd.
24.	DE143 – Commuter And Road Infrastructure Works In Pasir Ris And Loyang, Flora Road And Flora Drive.	Pre-Construction Condition Survey	02/01/2020	29/11/2022	Eng Lam Contractors Co (Pte) Ltd.
25.	CR1079 - Sewer And Water Diversion Works (Package B).	Pre-Construction Condition Survey	24/12/2019	28/03/2020	CCECC Singapore Pte. Ltd.
26.	TR315 - Proposed Silver Zone Scheme.	Pre-Construction Condition Survey	29/11/2019	15/02/2021	Megastone Holdings Pte. Ltd.
27.	Proposed Road Widening And Related Works At Serangoon North Ave 1 (Serangoon Planning Area).	Pre-Construction Condition Survey	23/09/2019	15/10/2019	ALN Engineering Pte. Ltd.
PUB Projects					
28.	Proposed Twin 1800mm Diameter Water Pipelines From Bishan Road To Woodleigh Park.	Pre-Construction Condition Survey	18/08/2023	Ongoing	YTL CE & Builder Pte. Ltd.
29.	Proposed 900mm To 1600mm Diameter Industrial Water Pipelines Along Tembusu Avenue And Jurong Island Highway - Contract 4	Pre-Construction Condition Survey	24/03/2023	20/07/2023	YTL CE and Builder Pte. Ltd.
30.	Construction Of Link Sewers For The Dtss Phase 2 Project - Schedule Iii Contract 2 (Old Choa Chu Kang Road / Jalan Bahar) (Balance Works).	Pre-Construction Condition Survey	15/10/2021	14/06/2023	Ed. Zublin AG (Singapore Branch)
31.	Tuas Water Reclamation Plant (Twrp) – Contract 3a – Industrial Liquids Modules Civil And Building Services Works.	Pre-Construction Condition Survey	14/01/2021	04/05/2021	China Construction (South Pacific) Development Co. Pte. Ltd.
32.	Seraya Firewater Network Line Project.	Pre-Construction Condition Survey	13/11/2020	08/06/2021	CNC General Contractors Pte. Ltd.
33.	Improvement To PA Camp And Parbury Outlet Drains (From East Coast Parkway To The Sea).	Pre-Construction Condition Survey	15/10/2020	19/10/2020	CPC Construction Pte. Ltd.

S/N	Project Title	Description of Works	Commencement Date	Completion Date	Client
34.	Provision Of Worker Dormitories For DTSS Phase 2 Project @ Penjuru Road.	Pre-Construction Condition Survey	21/08/2020	02/11/2020	Conint Pte. Ltd.
35.	Contract 4A – Biosolids and Digesters For The Tuas Water Reclamation Plant.	Pre-Construction Condition Survey	16/06/2020	29/06/2020	CES_SDC Pte. Ltd.
36.	Proposed 1600mm Diameter Water Pipeline Along Still Road South, Still Road And Jalan Eunus.	Pre-Construction Condition Survey	06/01/2020	05/08/2021	Aik Leong Plumbing Construction Pte. Ltd.
HDB Projects					
37.	HDB 38 Jalan Bahagia	Pre-Construction Condition Survey	12/11/2024	02/12/2024	Ipoise Pte. Ltd.
38.	Proposed Public Housing Development Comprising Of 1 Block Of 32/40 Storey And 1 Block Of 36/40 Storey Residential Blocks, 1 Block Of 6/7 Storey Multi-Storey Carpark With Roof Garden, Eating House, Supermarket And Ess, 1 Block Of Child Care Centre, 2 Blocks Of Precinct Pavilion On Lot 05961t Pt/ 00451m Pt, Mukim 17 At Jalan Rajah.	Pre-Construction Condition Survey	01/08/2024	29/08/2024	Newcon Builders Pte. Ltd.
39.	HDB – (A) Construction Of Sin Ming Street (Part 1); (B) Trunk Sewer Diversion At Sin Ming Estate.	Pre-Construction Condition Survey	02/05/2024	19/06/2024	Samkang Construction Pte. Ltd.
40.	(Project Cp) Bukit Batok Neighbourhood 4 Contract 27 – Proposed New Erection Of Public Housing Development Comprising 5 Blocks Of 14 Storey Residential Building [Total 689 Units], 1 Block Of Multi-Storey Carpark With Childcare Centre At 1st Storey, Electrical Sub-Station, Roof Garden And 2 Precinct Pavilions On Lot 05303x Pt Mk 10 At Bukit Batok West Avenue 8 / Bukit Batok Road (Bukit Batok Planning Area).	Pre-Construction Condition Survey	07/03/2024	07/05/2024	LC&T Builder (1971) Pte. Ltd.
41.	(Yishun N5 C12) Proposed Public Housing Development Comprising 6 Blocks Of 14-Storey Residential Flats (725 Units), 1 Block Of 6 / 6 Multi-Storey Car Park With Roof Garden, Social Communal Facilities, Precinct Pavilions, Bin Centre& Ess At Yishun Ave 1.	Pre-Construction Condition Survey	07/03/2024	18/04/2024	LC&T Builder (1971) Pte. Ltd.
42.	Construction Of Bus Bays, Signalized Traffic Junction Cum U-Turn, Cycling Path And Linkways At Jalan Boon	Pre-Construction Condition Survey	21/09/2023	19/10/2023	NU Systems Pte. Ltd.

S/N	Project Title	Description of Works	Commencement Date	Completion Date	Client
	Lay / Boon Lay Way.				
43.	Construction Of Covered Linkways (Batch 60) At Bishan East – Thomson Road Proposed Construction Of DOP At Block 313 Shunfu Road.	Pre-Construction Condition Survey	11/03/2020	06/04/2020	NU Systems Pte. Ltd.
44.	HDB Improvement Works To Surface Car Park (SCP) Batch 80.	Pre-Construction Condition Survey	23/09/2019	16/04/2021	CCECC Singapore Pte. Ltd.
45.	Proposed 3 Blocks Of Residential Building & 1 Block Of Car Park At Jurong West St. 93 Upp Jurong Rd N9C20.	Pre-Construction Condition Survey	26/08/2019	23/09/2019	LC&T Builder (1971) Pte. Ltd.
46.	Construction Works For A 5/6-Storey Multi Storey Car Park At Hougang Street 21.	Pre-Construction Condition Survey	26/08/2019	30/09/2019	LC&T Builder (1971) Pte. Ltd.
JTC Projects					
47.	Construction Of Road, Drain And Sewer At Tukang – Phase 2A.	Pre-Construction Condition Survey	11/10/2019	26/11/2019	Eng Lam Contractors Co (Pte) Ltd.
48.	Proposed 9-Storey Light Industrial Development At Woodlands Avenue 4 & 9 (JTC Innovation Precinct) (Woodlands Planning Area).	Pre-Construction Condition Survey	30/09/2019	13/01/2020	ALN Engineering Pte. Ltd.
Conservation Projects					
49.	Proposed Conservation And Additions & Alterations To Existing 3-Storey Conservation Building With New Erection Of 7 Storey Rear Extension Serviced Apartment Use (7 Units), And Additions & Alterations To Existing 3 Storey Conservation Building With 8 Storey Rear Extension For Residential Flats On Lot 01072k Ts 21 & 01575a Ts 21 301 & 303 River Valley Road (River Valley Planning Area).	Pre-Construction Condition Survey	07/09/2020	26/10/2020	189 Builder Pte. Ltd.
A&A/ Renovation/ Refurbishment Projects					
50.	A&A Works To Dawson Place And Fajar Shopping Centre	Pre-Construction Condition Survey	16/12/2024	Ongoing	Weima Builders Pte. Ltd.

S/N	Project Title	Description of Works	Commencement Date	Completion Date	Client
51.	Construction Of New Buildings, A&A Works, Taxiway Construction And Ancillary Works In Murai And Tengah.	Pre-Construction Condition Survey	27/09/2024	Ongoing	Expand Construction Pte. Ltd.
52.	Project: Proposed Additions And Alterations To Facade Cladding Of The 4 Single Purpose Factory On Lot 01995k & 02013k Mk01 At 239 Alexandra Road, Singapore 159930 (Bukit Merah Planning Area).	Pre-Construction Condition Survey	23/09/2024	28/10/2024	SG Facade Engineering Pte. Ltd.
53.	Proposed Addition And Alteration Works At 26 Evans Road.	Pre-Construction Condition Survey	13/09/2024	15/10/2024	D'Perception Singapore Pte. Ltd.
54.	Relodgement Of Proposed Addition And Alteration Works To The Existing Single-User Factory Building On Lot 01520v Mukim 13 At No. 23 Senoko Avenue (Sembawang Planning Area).	Pre-Construction Condition Survey	03/09/2024	09/10/2024	Isoteam Aet Pte. Ltd.
55.	SAA - Proposed Additions & Alterations And New Extension To Existing Singapore Aviation Academy On Lot 02071m, Mk31 At Aviation Drive (Changi Planning Area).	Pre-Construction Condition Survey	29/08/2024	20/09/2024	Tiong Seng Contractors (Pte) Ltd
56.	Addition And Alteration To Singapore Polytechnic Teaching Block 14 To 18 And Auditorium For Fire Safety Works At Dover Road.	Pre-Construction Condition Survey	25/07/2024	01/10/2024	Tracebuild Pte.Ltd.
57.	Proposed Extension, Alteration And Addition To An Existing Multi-Storey Car Park (Mscp) Block On Lot 02481m Mk 29 At Pasir Ris Industrial Drive 1 (Pasir Ris Planning Area).	Pre-Construction Condition Survey	13/06/2024	On Going	CTR Holdings Ltd
58.	Additions And Alterations Works Of 4th Storey And Addition Of 5th And 6th Storey At 203 Kallang Bahru.	Pre-Construction Condition Survey	12/03/2024	29/04/2024	Topzone E&C Pte. Ltd.
59.	Proposed Additions & Alterations To Existing Part Single-Storey / Part 4-Storey And Part 8-Storey Single-User, Single-Occupier Warehouse Building On Lot 09529v Mk 27 At No. 9 Changi South Street 3 (Tampines Planning Area).	Pre-Construction Condition Survey	12/01/2024	29/02/2024	ZGG Pte. Ltd.
60.	Project: Design And Construction Of Terminal 4 New Check-In Row	Pre-Construction Condition Survey	04/01/2024	20/03/2024	Takenaka Corporation Singapore Office
61.	Proposed Additions And Alterations To The Existing City Square Mall Ts17 On Lots 02463m, 02464w, 02706n,	Pre-Construction Condition Survey	12/12/2023	Ongoing	Sunray Woodcraft Construction Pte. Ltd.

S/N	Project Title	Description of Works	Commencement Date	Completion Date	Client
	02847m, 80004x & 80006l At 180 Kitchener Road (Kallang Planning Area).				
62.	Proposed Additions And Alterations To Existing 3-Storey Conservation Building With Basement And Attic Involving A New 7-Storey Rear Extension With Basement For Residential Use (Total: 20 Units) on Lots 99503l, 99504c & 99505m Ts 19 At No 2, 4 & 6 Mount Emily Road (Rochor Planning Area).	Pre-Construction Condition Survey	23/10/2023	13/12/2023	Hua Leong Group Pte. Ltd.
63.	Proposed Addition & Alteration To The Existing 12 Units 2-Storey Terrace Flats At 261 Macpherson Road.	Pre-Construction Condition Survey	23/10/2023	20/12/2023	Lloyd & Andrew Builders Pte. Ltd.
64.	Proposed Additions & Alterations To Existing Night Safari For A New Creatures Of The Night Trail And Exhibits At Mk14 Lot 01891m Pt At 80 Mandai Lake Road (Central Water Catchment Planning Area).	Pre-Construction Condition Survey	19/10/2023	04/11/2023	Builder 90 Pte.Ltd.
65.	Proposed Additions And Alterations To Existing 3-Storey Semi-Detached Dwelling House With An Attic On Lot 04785m Mk 27 At No 44 Senette Lane, Singapore 466938 (Bedok Planning Area).	Pre-Construction Condition Survey	26/09/2023	20/11/2023	Greatland Building Construction Pte. Ltd.
66.	Package B - A&A Works To Defu Industrial Estate And Kampong Ubi Industrial Estate.	Pre-Construction Condition Survey	26/08/2023	27/10/2023	Tracebuild Pte. Ltd.
67.	Proposed Additions & Alterations To Existing 2-Storey Terrace House On Lot 1444 Mk 17 At No 60 Jalan Riang For Madam Yeo Poh Khim.	Pre-Construction Condition Survey	04/08/2023	26/09/2023	Light-Pro Furnishings Pte.Ltd.
68.	Proposed Addition And Alterations To The Existing 6 th Storey Association Building (Lam Ann Building) On Lot 99440c Ts21 At 30 Mohamed Sultan Road (River Valley Planning Area).	Pre-Construction Condition Survey	31/07/2023	28/08/2023	BoldTek Projects Pte. Ltd.
69.	Proposed Additions And Alterations To The Existing City Square Mall Ts17 On Lots 02463m, 02464w, 02706n, 02847m, 800004x & 80005l At 180 Kitchener Road (Kallang Planning Area).	Pre-Construction Condition Survey	28/07/2023	25/08/2023	Sunray Woodcraft Construction Pte. Ltd.

S/N	Project Title	Description of Works	Commencement Date	Completion Date	Client
70.	Proposed Additions & Alterations Of Existing Rc Floor Slab & Installation Of Material Handling System Line At 1 st Storey Airfreight Terminal High Bay Transit Warehouse On Part Lot 04562x Mk31 At 121 Airport Cargo Road Singapore 819480 (Changi Planning Area).	Pre-Construction Condition Survey	13/06/2023	28/07/2023	Asiapac Contracts Pte. Ltd.
71.	Telok Ayer Mrt Station A&A Works.	Pre-Construction Condition Survey	12/04/2023	02/05/2023	Shinryo Corporation
72.	Proposed Amendment To Approved Alterations And Additions Works To An Existing Office Unit #06-01 On Lot 13157c Mk 18 At No. 151 Lorong Chuan, New Tech Park Singapore 556741.	Pre-Construction Condition Survey	10/04/2023	14/04/2023	D'Centus Project Pte. Ltd.
73.	Proposed Additions, Alterations And Change Of Use Of 5-Units Of 2-Storey Terrace House (House No. 52, 53, 54, 55 & 56 At Kampong Java Road) To Institutional Use With Cafeteria At House No. 52 Only And Provision Of Common Car Park On Lot 02782a Pt Ts 18.	Pre-Construction Condition Survey	10/04/2023	18/05/2023	Success Forever Construction & Maintenance Pte. Ltd.
74.	Proposed Additions And Alterations To Existing Laboratory At W3110e At Workshop 3 (W3) Of Singapore Polytechnic On Lot 05219v Mk03 At 500 Dover Road (Queenstown Planning Area).	Pre-Construction Condition Survey	31/03/2023	06/04/2023	Hoyi System Pte. Ltd.
75.	Proposed Additions & Alterations To The Part Existing Single-User Single-Storey Warehouse Building And Part Existing 3-Storey Building With Change Of Use From Data Centre To Warehouse And Production With Ancillary Facilities On Lot 04485p Mk 07 At 1 Tuas Avenue 4, Singapore 639382.	Pre-Construction Condition Survey	16/03/2023	10/04/2023	PT-G Builders Pte. Ltd.
76.	Proposed Additions & Alterations And Upgrading Works To Existing Single Storey Holland Village Hawker Centre/ Wet Market On Lot 98651a (Sl) Mk04 At 1, Lorong Mambong, Singapore 277700.	Pre-Construction Condition Survey	14/03/2023	31/03/2023	Logistics Construction Pte. Ltd.
77.	Proposed Additions And Alterations To Existing 2nd Storey Of Existing 7 Storey Office Building With 2 Basement Storey (Block T17) Involving Internal Partitioning Works At Singapore Polytechnic Mk03 On Lot	Pre-Construction Condition Survey	07/03/2023	21/03/2023	Hoyi System Pte. Ltd.

S/N	Project Title	Description of Works	Commencement Date	Completion Date	Client
	01797a, 02266n, 03049m & 05219v At 500 Dover Road 9 (Queenstown Planning Area).				
78.	Renovation Works At 17 Carpmael Road.	Pre-Construction Condition Survey	02/02/2023	20/02/2023	Block A Stalk Design Pte. Ltd.
79.	Proposed Additions And Alterations To Existing General Industrial Development (Block N1) On Lot 2622c Mk 06 At 249 Jalan Boon Lay Singapore 619523 (Jurong West Planning Area).	Pre-Construction Condition Survey	31/12/2022	12/01/2023	Tang's Engineering Pte.Ltd.
80.	Proposed Office Renovation Works At 166 Bukit Merah Central, #03-3527, Singapore 150166 For Tanjong Pagar Town Council.	Pre-Construction Condition Survey	10/12/2022	30/12/2022	C.P. Ong Construction Pte.Ltd.
81.	Renovation Works At 8 Jalan Tari Zapin.	Pre-Construction Condition Survey	07/10/2022	07/11/2022	Amber Services Pte.Ltd.
82.	Proposed Addition And Alteration Involving Replacement Of Damaged Asbestos Roof To Metal Sheet Roof And Replacement Of Damaged Timber Members To The Existing 2-Storey With Basement Residential Building (Block C & D) On Lot 99333p Ts 19 At 11 Upper Wilkie Road, Singapore 228120 (Rochor Planning Area).	Pre-Construction Condition Survey	22/08/2022	14/10/2022	Success Forever Construction & Maintenance Pte. Ltd.
83.	Proposed A&A Works To Existing Vehicular Immigration Booths At Woodlands And Tuas Land Checkpoints.	Pre-Construction Condition Survey	12/08/2022	16/09/2022	Y-5G Builders Pte. Ltd.
84.	Proposed Development Of Two (2) Single-Storey Houses, And Addition And Alteration Works To Two (2) Conservation Houses In Orchard Road (Prime Minister's Office – PMO).	Pre-Construction Condition Survey	21/06/2022	02/11/2022	Sunray Woodcraft Construction Pte. Ltd.
85.	Proposed Addition And Alteration To Existing 2-Storey Conserved Bungalow Mk02 On Lot 00905w 26, Ridout Road (Tanglin).	Pre-Construction Condition Survey	28/02/2022	07/03/2022	Soilbuild Construction Group Ltd
86.	Proposed Addition & Alteration At Existing Bukit Clubhouse At Sime Road.	Pre-Construction Condition Survey	08/02/2022	01/03/2022	Conint Pte. Ltd.

S/N	Project Title	Description of Works	Commencement Date	Completion Date	Client
87.	Proposed Additions And Alterations To Existing Hdb Blocks 865 To 868, Blocks 870 To 880 (Batch 3 Nrp) On Lots 1435w, 1267x & 1268l Mk 19 At Yishun Street 81 (Yishun Planning Area) & Proposed Ancillary Works To Batch 5 Nrp At Blocks 850 To 855 & Blocks 858 To 864 On Lots 1267x, 1268l, 1435w, 2267k, & 2268n Mk19 At Yishun Street 81, Yishun Ring Road & Yishun Avenue 4.	Pre-Construction Condition Survey	05/01/2022	24/06/2022	C.P. Ong Construction Pte. Ltd.
88.	Proposed Additions & Alterations To An Existing 2-Storey Detached Dwelling House Into A 2-Storey Envelope Control Detached Dwelling House On Lot 01033p Mk 04 At 25a King Albert Park (Bukit Timah Planning Area).	Pre-Construction Condition Survey	16/11/2021	13/12/2021	B S Construction Services Pte. Ltd.
89.	Minor Refurbishment Of The Property At 11 Folkestone Road, Singapore 139587.	Pre-Construction Condition Survey	08/06/2021	28/06/2021	Fullhouse Interior Render Pte. Ltd.
90.	Proposed Addition & Alteration To The Existing 2-Storey Corner Terrace Dwelling House With An Attic On Lot 06269n Mk 22 At 21b Jalan Tani Singapore 548561 (Hougang Planning Area).	Pre-Construction Condition Survey	27/05/2021	14/06/2021	Yew Seng Heng Construction Pte. Ltd.
91.	Proposed Addition And Alterations To Existing 6-Storey Commercial Building With Restaurant At 1st & 2nd Storey And Offices Above On Lots 00336x, 00333a, 00330v Ts07, 28 North Canal Road Singapore 059284.	Pre-Construction Condition Survey	06/05/2021	31/05/2021	Prime Structures Engineering Pte. Ltd.
92.	Proposed Additions And Alterations To The Existing 2-Storey Strata - Landed Dwelling House With A Basement At #01-12 Villa Chancery On Lot 05969w Mk 17 At 39 Chancery Lane (Novena Planning Area).	Pre-Construction Condition Survey	30/04/2021	31/05/2021	Greatland Building Construction Pte. Ltd.
93.	Proposed Addition And Alterations Works At 18 Tai Keng Lane. Singapore 535268.	Pre-Construction Condition Survey	26/04/2021	10/05/2021	Distinctidentity Pte. Ltd.
94.	Proposed Additions & Alterations (A&A) Works To The Existing Berth J9 And Moon Pools At Jurong Port.	Pre-Construction Condition Survey	21/04/2021	17/05/2021	Antara Koh Pte. Ltd.
95.	Proposed Retention Work, Additions And Alterations To Good Glass Bungalow On Mk 15 Lot 99586p At 120 Windsor Park Road (Bishan Planning Area).	Pre-Construction Condition Survey	13/03/2021	20/04/2021	Art & Architecture Pte. Ltd.

S/N	Project Title	Description of Works	Commencement Date	Completion Date	Client
96.	Proposed Renovation Works #05-01 At 20 Changi Business Park Central 2, Singapore.	Pre-Construction Condition Survey	19/03/2021	14/04/2021	DesignHub International Pte. Ltd.
97.	Proposed Additions And Alterations To Existing 2-Storey Terrace House With Lower Ground At 96 Cactus Road.	Pre-Construction Condition Survey	24/02/2021	19/03/2021	Super Sunny renovation Pte. Ltd.
98.	Renovation Works Of Kitchen, Bedrooms And Toilets To 26 Casuarina Road Singapore 579414.	Pre-Construction Condition Survey	22/01/2021	08/03/2021	Lloyd & Andrew Builders Pte. Ltd.
99.	Proposed Renovation Works #04-02 At 20 Changi Business Park Central 2, Singapore.	Pre-Construction Condition Survey	20/01/2021	01/02/2021	Office Empire Pte. Ltd.
100.	Proposed Additions And Alterations To Existing 3-Storey Building Involving Addition Of Roo Mezzanine And Change Of Use To The 1 st Storey Unit To Shop And The 2 nd , 3 rd Storey And Mezzanine To Residential Use On Lot 00450w Ts06 At 30 Temple Street (Chinatown [Kreta Ayer] Conservation Area).	Pre-Construction Condition Survey	28/12/2020	09/03/2020	Vision Foundation Pte. Ltd.
101.	Proposed A&A Works To Existing 3-Storey Conserved Shophouse With Roof Mezzanine Change Of Use To Hotel (11 Rooms) With Ancillary Take-Away Food Shop At 1st Storey And Office At Roof Mezzanine On Ts14 Lot 00084k At 78 Arab Street (Kampong Glam Conservation Area).	Pre-Construction Condition Survey	17/12/2020	11/02/2021	Vision Foundation Pte. Ltd.
102.	Proposed Additions & Alterations To Existing 5-Storey Classroom Block And 4-Storey Administration Block For Hwa Chong International School On Lot 02540c Mk02 At 663 Bukit Timah Road, Singapore 269783.	Pre-Construction Condition Survey	09/12/2020	19/01/2020	Cheng Yap Construction Pte. Ltd.
103.	Proposed Additions And Alteration To Existing 2-Storey Semi-Detached Dwelling House With An Attic On Lot 01936w Mk 04 At 3 Moonbeam Drive.	Pre-Construction Condition Survey	12/12/2020	25/02/2021	Plus Point Builders Pte. Ltd.
104.	Proposed Renovation Works At 43 Jalan Gumilang, Singapore 668882.	Pre-Construction Condition Survey	08/12/2020	05/01/2021	R&E Green Earth Concept Renovation
105.	Proposed Renovation Works #05-04a At 20 Changi Business Park Central 2, Singapore.	Pre-Construction Condition Survey	04/12/2020	14/12/2020	LTR Pte. Ltd.
106.	Proposed Additions And Alterations To Existing House No. 19, Jalan Intan, Lot 862 Mk X For Mdm Phua Mui	Pre-Construction Condition Survey	04/12/2020	14/01/2021	Jansen Sc International Pte. Ltd.

S/N	Project Title	Description of Works	Commencement Date	Completion Date	Client
	Feng.				
107.	Addition And Alteration Works To Zion Riverside Food Centre On Lot 00990n Ts24 At Zion Road (Tanglin Planning Area).	Pre-Construction Condition Survey	02/11/2020	21/11/2020	Success Forever Construction & Maintenance Pte. Ltd.
108.	Proposed 18 Sets Of New Aluminium Canopy At Private Enclosed Space (Pes), Park Place Residences.	Pre-Construction Condition Survey	23/10/2020	12/11/2020	Nova Façade Pte.Ltd.
109.	Proposed Renovation Works To Existing 2-Storey Terrace House At 29 Jalan Riang.	Pre-Construction Condition Survey	16/10/2020	04/11/2020	Icon Studio Pte. Ltd.
110.	Proposed Additions & Alterations To Existing Bugis Junction Towers Involving Interiors And Façade Works On Lot Ts 13-0 10 15c At 230 Victoria Street (Downtown Core Planning Area).	Pre-Construction Condition Survey	15/10/2020	20/11/2020	Sunray Woodcraft Construction Pte. Ltd.
111.	Proposed Additions & Alterations To An Existing 2 Storey Chinese Temple And Ancillaries On Lot 02600a Mk 13 At 10 Marsiling Industrial Estate Road 3, Singapore 739254,	Pre-Construction Condition Survey	25/09/2020	22/10/2020	Da-Qiao Enterprise Pte. Ltd.
112.	Renovation Works at 3 Temasek Ave, #11-02 Centennial Tower, Singapore 039190.	Pre-Construction Condition Survey	05/09/2020	21/09/2020	UV Resources Pte. Ltd.
113.	Proposed Change Of Use From Clean & Light Industrial Usage To Civic Institution Including Additions And Alterations To Existing 8 Storey Building On Lot 3145m, Mk 24 At 2 Soon Wing Road (Geylang Planning Area).	Pre-Construction Condition Survey	01/09/2020	07/10/2020	CP Ong Construction Pte. Ltd.
114.	Proposed Renovation Works At 20 Changi Business Park Central 2, Singapore.	Pre-Construction Condition Survey	28/08/2020	11/09/2020	Build & Design Consultants Pte. Ltd.
115.	Proposed Additions & Alterations To The Existing 2-Storey Building With A Basement For Malabar Mosque With A New 2-Storey Annex Block With Basement Extension On Lots 00381a Pt, 00382k Pt, 99834k Pt, 99835n Pt, 99837l Pt Ts 14 At 471 Victoria Street, Singapore 198370 (Rochor Planning Area).	Pre-Construction Condition Survey	20/07/2020	01/09/2020	Mie-Tech Engineering & Construction Pte. Ltd.
116.	Proposed A&A To The Existing Office Building Involving Basement 3 To Upper Roof Storey Internal Fitout Works	Pre-Construction Condition Survey	29/06/2020	29/07/2020	PBT Engineering Pte. Ltd.

S/N	Project Title	Description of Works	Commencement Date	Completion Date	Client
	On Lot 00453C TS01 At 21 Collyer Quay.				
117.	Proposed A&A Works Involving Construction Of Protective Armoury On Existing Pasir Panjang Scanning Station, Tanah Merah Ferry Terminal, Changi Airfreight Centre, Woodlands Checkpoint & Tuas Checkpoint.	Pre-Construction Condition Survey	25/06/2020	05/08/2020	Y-5G Builders Pte. Ltd.
118.	Proposed Additions And Alterations Of Existing 2-Storey Intermediate Terrace House At 327 Guillemard Road (Geylang Planning Area) And Proposed Additions And Alterations Of Existing 1-Storey Corner Terrace House At 329 Guillemard Road (Geylang Planning Area).	Pre-Construction Condition Survey	23/06/2020	15/07/2020	Conint Pte. Ltd.
119.	Proposed Additions & Alterations To Existing 8-Storey Building At 202 Kallang Bahru, Singapore 339339.	Pre-Construction Condition Survey	17/06/2020	16/07/2020	UV Resources Pte. Ltd.
120.	Proposed Renewal To Lecture Theatres At Faculty Of Engineering And Faculty Of Arts And Social Sciences, National University Of Singapore.	Pre-Construction Condition Survey	03/06/2020	17/08/2020	Debenho Pte. Ltd.
121.	Proposed Additions & Alterations To The Existing 2-Storey Semi-Detached Dwelling House At 27 Jalan Seaview (Marine Parade Planning Area).	Pre-Construction Condition Survey	01/04/2020	24/04/2020	Innospatial Pte. Ltd.
122.	Proposed Additions & Alterations To Existing Office Block A, B And C At 1557 Keppel Road (Bukit Merah Planning Area).	Pre-Construction Condition Survey	23/03/2020	06/08/2020	ZH Builders Pte. Ltd.
123.	Proposed Additions & Alterations To Existing 2-Storey Terrace House And Rear Extension On Lot 07237t Mk22 At 59 Highland Road Singapore 549143 (Hougang).	Pre-Construction Condition Survey	05/03/2020	02/04/2020	Treasure Pod Pte. Ltd.
124.	Proposed Additions And Alterations To Existing Single Storey Detached Factory To A 2-Storey Detached Factory At 27 Benoi Place For Pacific Central Teknik Pte. Ltd.	Pre-Construction Condition Survey	17/02/2020	20/03/2020	Mutiara (FE) Pte. Ltd.
125.	Additions & Alterations To Supreme Court At Supreme Court Lane.	Pre-Construction Condition Survey	10/01/2020	27/09/2021	Sunray Woodcraft Construction Pte. Ltd.
126.	Proposed Additions & Alterations To Existing Gongshang Primary School And Jurong Primary School.	Pre-Construction Condition Survey	30/12/2019	04/02/2020	Wan Chung Construction (Singapore) Pte. Ltd.

S/N	Project Title	Description of Works	Commencement Date	Completion Date	Client
127.	Proposed Additions And Alterations To An Existing 2 Storey Intermediate Terrace House At 72 Jalan Lanjut.	Pre-Construction Condition Survey	02/12/2019	24/12/2019	Harvest Chain Pte. Ltd.
128.	Proposed Extension To Existing 3 Blocks Of Columbarium At 950 Old Choa Chu Kang Road (Western Water Catchment Area) – Block B.	Pre-Construction Condition Survey	25/11/2019	26/12/2019	Precise Development Pte. Ltd.
129.	Proposed Addition And Alteration Works To Existing 3-Storey Building At 3779 Jalan Bukit Merah S159462.	Pre-Construction Condition Survey	21/11/2019	27/11/2019	C.P. Ong Construction Pte. Ltd.
130.	Proposed Addition Of 1 Storey New Locker And Changing Room To Existing 2-Storey Mechanical Service Building At 1 Ayer Chawan Place Jurong Island For Exxonmobil Asia Pacific Pte Ltd.	Pre-Construction Condition Survey	11/11/2019	29/11/2019	G & C General Contractors (Pte) Ltd.
131.	Proposed Addition & Alteration, Fitting Out Works To 5th, 6th, 7th, 8th, 9th, 10th & 14th Floors Of Existing Office Building, Bugis Junction Office Tower At 230 Victoria Street, Singapore For Enterprise Singapore.	Pre-Construction Condition Survey	24/10/2019	06/11/2019	Sunray Woodcraft Construction Pte. Ltd.
132.	Proposed Addition And Alteration Works Involving A New Lift To Existing Church Of Saint Michael AT 17 Saint Michael's Road Singapore 327976.	Pre-Construction Condition Survey	21/10/2019	06/11/2019	ML Prospec (Singapore) Pte. Ltd.
133.	Proposed Additions And Alterations For Addition Of Truck Loading Bay, Pipebridges, Pumps, Air Fin Heaters And Ancillaries To Existing Storage Terminal, Mukim 34 At 51 Banyan Avenue (Western Islands Planning Area).	Pre-Construction Condition Survey	07/10/2019	25/10/2019	Overseas Technical Engineering and Construction Pte.Ltd.
134.	Proposed Additions And Alterations To Existing 4-Storey Block (Conversion To Service Apartment) At 1A, Lutheran Road.	Pre-Construction Condition Survey	25/9/2019	15/10/2019	UV Resources Pte. Ltd.
135.	Proposed Additions And Alterations Of Existing Tennis Courts To Playground And Swimming Pool At 1 st Storey Of Existing Shangri-La Hotel At 22, Orange Grove Road (Tanglin Planning Area).	Pre-Construction Condition Survey	17/09/2019	03/10/2019	Sunray Woodcraft Construction Pte. Ltd.
Other Projects					
136.	Replacement Of Mechanical And Electrical Systems And Addition Of Electronic Security System To Existing Buildings And Ancillary Works At Paya Lebar And	Pre-Construction Condition Survey	03/12/2024	Ongoing	Fonda Global Engineering Pte. Ltd.

S/N	Project Title	Description of Works	Commencement Date	Completion Date	Client
	Tengah.				
137.	Proposed Demolition Of Existing Factory Buildings And Ancillary Structures At Gul Circle, Kranji Way, Sungei Kadut And Penjuru Road.	Pre-Construction Condition Survey	29/11/2024	Ongoing	Peng Chuan Engineering Construction Pte Ltd.
138.	Proposed Demolition Of Raffles Pier And Dolphin At The Existing Shipyard At 51 Pioneer Sector 1.	Pre-Construction Condition Survey	29/11/2024	Ongoing	Antara Koh Pte. Ltd.
139.	Renovation Of Gallery & Office Functional Spaces In Singapore Tyler Print Institute.	Pre-Construction Condition Survey	26/11/2024	16/12/2024	Mutiara (Fe) Pte. Ltd.
140.	Sembcorp's Centralized Banyan Warehouse, Jurong Island	Pre-Construction Condition Survey	14/11/2024	Ongoing	Sembcorp Specialised Construction Pte. Ltd.
141.	Project At 65 Seletar Green View.	Pre-Construction Condition Survey	14/11/2024	02/12/2024	Ideal House Pte. Ltd.
142.	Project 1: Proposed Erection Of A 4-Storey Maximum Containment Facility (Bsl-3 & Bsl-4 Lab) To The Existing Dso Marina Hill Premises On Lot 03815k Mk 03 At 11 Stockport Road (Queenstown Planning Area). Project 2: Proposed Additions & Alterations To The Existing 3-Storey Research & Development Building (Block 6) With 1 Level Basement On Lot 03815k Mk 03 At 11 Stockport Road (Queenstown Planning Area).	Pre-Construction Condition Survey	07/11/2024	Ongoing	Shimizu – Dai Dan Joint Venture
143.	Project: Proposed Demolition Of Existing Factory Buildings And Ancillary Structures At Tuas Basin Close.	Pre-Construction Condition Survey	06/11/2024	Ongoing	Peng Chuan Engineering Construction Pte. Ltd.
144.	Project Jtc Space@Tuas.	Pre-Construction Condition Survey	24/10/2024	Ongoing	Busways Pte. Ltd.
145.	Jurong Island, 51 Sakra Avenue, Sembcorp.	Pre-Construction Condition Survey	08/10/2024	06/11/2024	JEL Maintenance Pte. Ltd.
146.	Upgrading Of Driveway Interlocking Pavers At Block 225to 230 Pasir Ris Street 21.	Pre-Construction Condition Survey	30/09/2024	08/10/2024	I. Z. Specialist Pte. Ltd.
147.	Modification Works To The Existing Rc Beam At Sgh Block 1.	Pre-Construction Condition Survey	27/09/2024	24/10/2024	China Construction (South Pacific) Development Co Pte.Ltd.

S/N	Project Title	Description of Works	Commencement Date	Completion Date	Client
148.	Project: So Drama - Proposed Erection Of An 8 Storey Building With Basement Carpark And 1 Storey Centralised Cooling Plant On Lot 18265v (Pt) Mk At 18 Ang Mo Kio Drive (Ang Mo Kio Planning Area).	Pre-Construction Condition Survey	20/09/2024	04/11/2024	Tiong Seng Contractors (Pte) Ltd.
149.	Project: 53 Conway Grove.	Pre-Construction Condition Survey	19/09/2024	01/11/2024	BS Construction Services Pte. Ltd.
150.	Proposed Erection Of 2-Storey Interim Ferry & Cruise Terminal With Covered Linkbridge To Ext'g L Pier, Covered Linkway To Ext'g Hft1, Minor A&A To Ext'g Hfc & L-Pier And Relocation Of Ext'g Jetties & pontoons On Lots 02915p, 03330k, 02888p, 03192w, 02889t, 02890v, 02891p & 03710v Mk01 At Maritime Square & Harbourfront Avenue (Bukit Merah Planning Area).	Pre-Construction Condition Survey	11/09/2024	11/12/2024	Antara Koh Pte. Ltd.
151.	Demolition And Reinstatement Of Marina Bay Golf Course At 80 Rhu Cross.	Pre-Construction Condition Survey	06/08/2024	30/08/2024	Peng Chuan Engineering Construction Pte. Ltd.
152.	Project Site: 70 Pasir Ris Industrial Drive 1.	Pre-Construction Condition Survey	02/08/2024	30/08/2024	Jansen SC International Pte. Ltd.
153.	Proposed Landed Housing Development (Phase 11 Total 161 Units) Comprising 1 Unit Of 3-Storey Envelope Control Detached Dwelling House With Attic, 146 Units Of 3-Storey envelope Control Terrace Dwelling Houses With Attic And 14 Units Of 3-Storey Envelope Control Terrace Dwelling Houses With Basement And Attic On Lot 18512c-Pt Mk18 At Luxus Hill Heights / Luxus Hill View / Luxus Hill Road (Serangoon Planning Area) – Phase 12.	Pre-Construction Condition Survey	11/07/2024	06/09/2024	ABV Systems Pte. Ltd.
154.	Proposed Erection Of A Single-User Industrial Development Involving New Workshops, Warehouses, Open Iso-Tank Storage Areas And Ancillary Office Block On Lot 08898v And 08893x Mk05 At 36 Penjuru Road Singapore 609149 (Jurong East Planning Area).	Pre-Construction Condition Survey	10/07/2024	10/10/2024	Weima Builders Pte. Ltd.
155.	Proposed Mixed-Use Development Magazine Road, Havelock Road & Keng Cheow Street.	Pre-Construction Condition Survey	02/07/2024	26/07/2024	Woh Hup (Private) Limited
156.	Project Site: Plot 12 Tuas South Avenue 16.	Pre-Construction Condition Survey	12/06/2024	19/06/2024	Pan-United Concrete Pte. Ltd.

S/N	Project Title	Description of Works	Commencement Date	Completion Date	Client
157.	Proposed Erection Of A 5-Storey Block With Two Basement Floor Of Commercial School For Management Development Institute Of Singapore (Mdis) At Mk 26 Lot 08764l, 190 Changi Road.	Pre-Construction Condition Survey	16/05/2024	04/07/2024	BHD Construction Pte. Ltd.
158.	Construction Works At Jurong Island.	Pre-Construction Condition Survey	14/05/2024	22/07/2024	JEL Maintenance Pte. Ltd.
159.	Proposed Demolition Of Finger Pier To The Existing Shipyard On Lots 00658l, 00659c, 00825w, 03996l, 03997c, 03998m, 04006t, 04267x, 04268l, 04269c, 04270x, 04271l & 04283n Mk 07 At 51 Pioneer Sector 1 (Pioneer Planning Area).	Pre-Construction Condition Survey	03/05/2024	22/06/2024	Sing Tec Development Pte. Ltd.
160.	Crisp Project - Package-2 Pipeline.	Pre-Construction Condition Survey	26/04/2024	27/05/2024	Agitech Innovations Pte. Ltd.
161.	Ahu And Vav Replacement For Suntec Tower 1, 2, 3 And 5.	Pre-Construction Condition Survey	02/04/2024	28/06/2024	D-Team Engineering Pte .Ltd.
162.	Proposed Slope And Drainage Works Behind Greenleaf Rise.	Pre-Construction Condition Survey	30/03/2024	24/04/2024	Success Forever Construction & Maintenance Pte. Ltd.
163.	Project Site: 15 Carpmael Road.	Pre-Construction Condition Survey	30/03/2024	23/04/2024	Block A Stalk Design Pte. Ltd.
164.	Proposed Ancillary Works To Neighbourhood Renewal Programme To Blocks 601-615 At Elias Road / Blocks 500-521 At Pasir Ris Street 52 And Reconstruction Of Existing Footbridge Across Sungei Api Api In Tandem With Nrp.	Pre-Construction Condition Survey	19/03/2024	17/05/2024	CPC Construction Pte. Ltd.
165.	Proposed Demolition Of Existing Buildings, Quay, Launchways, Jetty And The Reinstatement Works On Lots 03456a, 03455t & 04165n Mk 05 At 21 Pandan Road, Singapore.	Pre-Construction Condition Survey	12/03/2024	03/05/2024	Sing Tec Construction Pte. Ltd.
166.	Proposed Drain And Sewer Upgrading Work At Woodlands Road & Woodland Industrial Park D Street 2.	Pre-Construction Condition Survey	09/03/2024	22/04/2024	CPC Construction Pte.Ltd.
167.	Proposed New Erection Of A Envelope Control 3-Storey Intermediate Terrace Dwelling House On Lot 00739p Mk20 At No.12 Iqbal Avenue, Singapore 789455 (Ang	Pre-Construction Condition Survey	04/03/2024	29/04/2024	Leemax Development Co. Ltd

S/N	Project Title	Description of Works	Commencement Date	Completion Date	Client
	Mo Kio Planning Area).				
168.	Proposed Reconstruction To The Existing 2-Storey Intermediate Terrace Dwelling House To A 2-Storey Envelope Control Intermediate Terrace Dwelling House With New Attic On Lot 01478x Mk 17 At 254 Wolskel Road.	Pre-Construction Condition Survey	29/02/2023	19/03/2024	S.T. Design & Contract
169.	Survey & Inspection To 22, Jalan Pernama Changi, Singapore 499263.	Pre-Construction Condition Survey	01/02/2023	25/03/2024	Mr. James Yeo
170.	Proposed Design And Build Of The Arrival Pavilion And Shuttle Stop Near Mrt Site At Bay South, Gardens By The Bay, Singapore.	Pre-Construction Condition Survey	29/12/2023	06/08/2024	Weima Builders Pte. Ltd.
171.	Contract D/573/23 - (A) Site Clearance And Earthworks (Phase Ii) At Ang Mo Kio N8; (B) Construction Of Ang Mo Kio Street 81 (Part I), Ang Mo Kio Street 82 & Ang Mo Kio Drive (Part I) And (C) Construction Of Trunk Sewers (Part I) At Ang Mo Kio N8.	Pre-Construction Condition Survey	28/12/2023	01/04/2024	Megastone Holdings Pte. Ltd.
172.	Proposed Erection 1 Block Of Single-Storey Sport Hall And 2-Storey Building With Ancillary Retails, Ancillary F&B Use And Fitness Centers On Lot 05251p Pt Mk20 At Fernvale Link (Sengkang New Town Planning Area).	Pre-Construction Condition Survey	06/12/2023	15/01/2024	WSE Pte. Ltd.
173.	Proposed Erection Of 5-Storey Single-User Industrial Building At 80 Senoko Drive.	Pre-Construction Condition Survey	01/12/2023	05/03/2024	Sanwah Construction Pte. Ltd.
174.	Engineering, Procurement And Construction For Meranti Power Gas Metering Station.	Pre-Construction Condition Survey	30/11/2023	09/01/2024	RMA Fiventures Asia-Pacific Pte Ltd
175.	Proposed Strengthening Works And Rectification Works To Existing Piperack And Pipebridges At Grid Pb893 To Pb980, Pb1003-Pb1004 And Pb1040-Pb1043 To An Existing Service Corridor Along Sakra Road And Sakra Avenue On Lots 01011n-Pt & 03628c-Pt Mk 34 At Sakra Road, Jurong Island.	Pre-Construction Condition Survey	29/11/2023	25/01/2024	Hai Leck Engineering (Private) Limited
176.	Proposed New Erection Of A Pair Of 2-Storey Envelope Control Semi-Detached Dwelling Houses Each With An Attic And A Sunken Swimming Pool On Lot 98147k Mk	Pre-Construction Condition Survey	15/11/2023	06/02/2024	ZH Builders Pte. Ltd.

S/N	Project Title	Description of Works	Commencement Date	Completion Date	Client
	27 At 11 Aida Street (Bedok Planning Area).				
177.	Proposed Erection Of A 3-Storey Envelope Control Intermediate Terrace Dwelling House With A Mezzanine, An Attic And A Swimming Pool On Lot 00895m Mk 26 At 79c Lorong N Telok Kurau (Bedok Planning Area).	Pre-Construction Condition Survey	15/11/2023	15/01/2024	ZH Builders Pte. Ltd.
178.	Proposed Erection Of 3-Storey Envelope Control Detached Dwelling House With An Attic, A Basement And A Sunken Swimming Pool (Breakaway) On Lot 06358m Mk 26 At 231 Tembeling Road (Marine Parade Planning Area).	Pre-Construction Condition Survey	15/11/2023	22/12/2023	ZH Builders Pte. Ltd.
179.	Demolition Works At House No. 2 To 6 Mount Emily Road.	Pre-Construction Condition Survey	26/10/2023	14/12/2023	Hua Leong Group Pte. Ltd.
180.	New Fit Out Work For Commercial Office At Aperia #14-10/13.	Pre-Construction Condition Survey	23/10/2023	03/11/2023	Jones Lang Lasalle Property Consultants Pte.Ltd.
181.	Proposed Erection Of A 3-Storey Envelope Control Intermediate Terrace Dwelling House With An Attic At 37 Jalan Lapang.	Pre-Construction Condition Survey	18/10/2023	05/12/2023	ZH Builders Pte.Ltd.
182.	Proposed Renovation Works For I&E Port Of Call Office (Innovation & Entrepreneurship) At Unit Lhn-B1-01a At The Arc In Nanyang Technological University.	Pre-Construction Condition Survey	17/10/2023	04/11/2023	Hoyi System Pte.Ltd.
183.	Minor Renovation Works In Main Building Operating Theatre (Mbot) Male Toilet.	Pre-Construction Condition Survey	08/10/2023	04/11/2023	C.P. Ong Construction Pte.Ltd.
184.	Construction At North Coast Avenue.	Pre-Construction Condition Survey	03/10/2023	27/10/2023	Sunseap Leasing Pte. Ltd.
185.	Proposed Erection Of A 34-Storey Commercial Building With 4 Basements On Lot 00419c Ts 01 At Collyer Quay (Downtown Core Planning Area).	Pre-Construction Condition Survey	03/10/2023	14/02/2024	Woh Hup (Private) Limited
186.	Proposed Erection Of A 2-Storey Envelope Control Intermediate Terrace Dwelling House With A Basement, An Attic And A Swimming Pool On Lot 01374x Mk 18 At 108 Jalan Kuras (Ang Mo Kio Planning Area).	Pre-Construction Condition Survey	03/10/2023	20/11/2023	ZH Builders Pte.Ltd.

S/N	Project Title	Description of Works	Commencement Date	Completion Date	Client
187.	Proposed Erection Of A 2-Storey Envelope Control Intermediate Terrace Dwelling House With A Basement, A Mezzanine, An Attic And Swimming Pool On Lot 00582m Mk 27 At 30 Fidelio Street (Bedok Planning Area).	Pre-Construction Condition Survey	03/10/2023	10/11/2023	ZH Builders Pte.Ltd.
188.	Project: 52 Jalan Greja.	Pre-Construction Condition Survey	29/09/2023	08/11/2023	Speedy Renovation Pte.Ltd.
189.	Project: 81 Lorong J Telok Kurau Singapore 425892.	Pre-Construction Condition Survey	20/09/2023	12/10/2023	Aspect International Pte. Ltd.
190.	Pipeline Project In Jurong Island Within Sembcorp Service Corridor.	Pre-Construction Condition Survey	19/09/2023	20/11/2023	Agitech Innovations Pte Ltd.
191.	Proposed New Erection Of Integrated Development Comprising Of 1 Block Of 8 Storey Sports/ Recreation/ Stadium/ Commercial/ Exhibition And Ancillary Facilites, With Single Storey Basement Carpark And Understage, On Lots 00386k Pt Ts10, 00605n Pt, 00810p Pt, 00872p, 00897m Pt, 00944p Pt, 70006t Pt Ts11 And 00539n Pt Ts30 At Raffles Ave (Downtown Core Planning Area).	Pre-Construction Condition Survey	14/09/2023	04/11/2023	Expand Construction Pte. Ltd.
192.	Proposed Demolition Of Existing Factory Buildings And Ancillary Structures At Tuas And Defu Lane.	Pre-Construction Condition Survey	31/08/2023	04/10/2023	Peng Chuan Engineering Construction Pte. Ltd.
193.	Construction Of Integrated Facilities, Ancillary Structures And External Works At Changi East (D2014-00169-C12a).	Pre-Construction Condition Survey	17/08/2023	22/09/2023	Expand Construction Pte. Ltd.
194.	Proposed Erection Of 14-Storey Purpose-Built Worker Dormitory On Lot 04738a Mk06 At Tukang Innovation Lane (Boon Lay Planning Area).	Pre-Construction Condition Survey	08/08/2023	30/08/2023	BHCC Construction Pte.Ltd.
195.	Renovation Works At 41 Limau Garden.	Pre-Construction Condition Survey	08/08/2023	12/09/2023	M&C Green Works Pte. Ltd.
196.	Refurbishment Of Air-Conditioning And Mechanical Ventilation (Acmv) Systems And Shared Infrastructure Systems In Biopolis.	Pre-Construction Condition Survey	26/07/2023	15/09/2023	D-Team Engineering Pte.Ltd.
197.	Elu) Electrical Load Upgrading, Electrical Rewiring And (R&R) Repairs & Redecoration Works At Balam / Circuit / Pipit Road, Aljunied Avenue 2 And Paya Lebar Way In	Pre-Construction Condition Survey	18/07/2023	11/09/2023	Raymond Construction Pte. Ltd.

S/N	Project Title	Description of Works	Commencement Date	Completion Date	Client
	Macpherson Division.				
198.	Construction Of A New Building And Ancillary Works At Jurong Camp.	Pre-Construction Condition Survey	03/07/2023	21/09/2023	Builder 90 Pte. Ltd.
199.	Proposed Interior Design & Fitting Out Works For Harley Davidson At 28 Leng Kee Road, Singapore 159109.	Pre-Construction Condition Survey	23/06/2023	23/07/2023	D' perception Singapore Pte. Ltd.
200.	Proposed Erection Of A 2-Storey Envelope Control Semi Detached House With An Attic On Lot Mk18-06885v At 10 Thomson Close, Singapore 575017 (Ang Mo Kio Planning Area).	Pre-Construction Condition Survey	13/06/2023	28/07/2023	BHD Construction Pte. Ltd.
201.	To Strengthen Existing Building Structure And Change Strata Title At 192 Bukit Timah Road, Singapore 229858.	Pre-Construction Condition Survey	09/06/2023	06/07/2023	CIWISE Consultants
202.	Construction And Upgrading Of Covered Linkways, Drop-Off Porches, Bfa Ramps, And Hardcourt At Tampines East, West, And Central Divisions.	Pre-Construction Condition Survey	06/06/2023	21/06/2023	C.P. Ong Construction Pte. Ltd.
203.	(Jurong East N2 C24) Proposed Public Housing Development Comprising Of 1 Block Of 38-Storey, 1 Block Of 22/26-Storey Residential Building (Total 562 Units), Multi-Storey Car Park, Ess, 1-Storey Resident Network Centre, 2-Storey Social Communal Facilities, And Precinct Pavilion On Lot 09393c Mk05 At Jurong East Street 24 (Jurong East Planning Area).	Pre-Construction Condition Survey	30/05/2023	10/07/2023	LC&T Builder (1971) Pte. Ltd.
204.	Proposed 3-Storey Semi-Detached House At 62 Paya Lebar Crescent.	Pre-Construction Condition Survey	29/05/2023	26/06/2023	Place Architects and Design Pte. Ltd.
205.	Proposed Erection Of A 5-Storey Building With Attic, Office On The 2nd Storey And Serviced Apartments (Total:11 Units) On The Remaining Floors On Lot Ts 16 00696c At Syed Alwi Road (Rochor Planning Area).	Pre-Construction Condition Survey	25/05/2023	08/08/2023	Weima Builders Pte. Ltd.
206.	Ceiling Inspection Work At Khoo Teck Puat Hospital.	Pre-Construction Condition Survey	18/05/2023	27/06/2023	CMK Engineering Consultants Pte. Ltd.
207.	Upgrading Of Swimming Pools And Toilets At Sembawang Country Club.	Pre-Construction Condition Survey	16/05/2023	01/06/2023	Conint Pte.Ltd.

S/N	Project Title	Description of Works	Commencement Date	Completion Date	Client
208.	Proposed Fee Quotation For Pre-Condition, Pre-Construction And Dilapidation Survey To Existing Good Class Bungalow At No. 28 Paradise Island, Sentose Cove	Pre-Construction Condition Survey	13/05/2023	Ongoing	Kewpie Architects
209.	Proposed Demolition Works For State Property-Batch 20 Project E	Pre-Construction Condition Survey	10/05/2023	06/06/2023	Peng Chuan Engineering Construction Pte. Ltd.
210.	Toilet Upgrading Projects At Mowbray Road.	Pre-Construction Condition Survey	18/04/2023	29/05/2023	LongXiang Construction Pte.Ltd.
211.	99 Luxus Hill Avenue	Pre-Construction Condition Survey	31/03/2023	23/05/2023	Jansen SC International Pte. Ltd.
212.	Proposed Erection Of A Single-User 8-Storey Corner Terrace Food Factory With Ancillary Office And Industrial Canteen Mk23 On Lot 03462w At 6 Kim Chuan Terrace (Hougang Planning Area).	Pre-Construction Condition Survey	22/02/2023	30/03/2023	Hua Leong Group Pte. Ltd.
213.	Proposed erection of one block of 5-storey flats (total 19 units) with attic, surface car park and provision for a swimming pool on Lots 06540W & 06541V MK26 at Lorong K Telok Kurau (Bedok Planning Area).	Pre-Construction Condition Survey	02/02/2023	24/02/2023	CPC Construction Pte.Ltd.
214.	Demolition Of La Ville Condo.	Pre-Construction Condition Survey	13/01/2023	06/03/2023	Peng Chuan Group Pte.Ltd.
215.	Road Access Area At 71g Loewen Road.	Pre-Construction Condition Survey	30/12/2022	12/01/2023	Success Forever Construction & Maintenance Pte. Ltd.
216.	Repair Of Road Defect At Choa Chu Kang Cemetry.	Pre-Construction Condition Survey	24/12/2022	30/12/2022	Success Forever Construction & Maintenance Pte. Ltd.
217.	Proposed Erection Of A Block Of 8 Storey Hotel Development (130 Rooms) With 2 Basement Carparks, Sky Terrace And A Rooftop Garden At Ts19-00411v And S19-00412p (Pt) At 189, Selegie Road, Singapore (Rochor Planning Area).	Pre-Construction Condition Survey	12/12/2022	14/02/2023	Hua Leong Group Pte. Ltd.
218.	Hmgics Project - Hyundai Motor Group Innovation Centre Singapore (8 Bulim Ave).	Pre-Construction Condition Survey	15/11/2022	19/12/2022	Communication Design International (Singapore) Pte.Ltd.
219.	Redevelopment Of 14, Dickson Road.	Pre-Construction Condition Survey	05/10/2022	30/10/2022	Maestro Bee Pte. Ltd.

S/N	Project Title	Description of Works	Commencement Date	Completion Date	Client
220.	Proposed New Erection Of Residential With Commercial At 1st Storey Development Comprising 1 Block Of 27-Storey Flat (Total: 275 Units) With Restaurants, 2 Facilities On Mk03 Lot 05528v At Slim Barracks Rise (Queenstown Planning Area).	Pre-Construction Condition Survey	18/09/2022	25/11/2022	Evan Lim & Co Pte. Ltd.
221.	Improvement Works To Car Park Hg36 (Blk 703 – 706, 711 – 712) At Hougang Avenue 2.	Pre-Construction Condition Survey	07/09/2022	17/10/2022	Samco Civil Engineering Pte. Ltd.
222.	For Project Site Along Marina Coastal Drive.	Pre-Construction Condition Survey	30/08/2022	18/04/2023	Skyports Pte. Ltd.
223.	Proposed Erection Of A Single-Use Industrial Development Comprising 1 Blk Of 2-Storey Ancillary Office, 1 Blk Of Part Single / Part 3-Storey Workshop, 2 Blks Of Single-Storey Workshops (Movable Sheds) & Ancillary Buildings On Lots 02643t Pt & 02855n Pt Mk 07 At Tuas Basin Close Singapore (Tuas Planning Area) – Demolition.	Pre-Construction Condition Survey	28/06/2022	18/08/2022	Peng Chuan Group Pte.Ltd.
224.	Construction For Connection Of Seraya Power Station At 3 Seraya Avenue.	Pre-Construction Condition Survey	20/05/2022	28/07/2022	RMA Fiventures Asia-Pacific Pte. Ltd.
225.	Proposed Demolition Works At Blk 90 & 92 Jalan Rajah.	Pre-Construction Condition Survey	24/04/2022	05/08/2022	Peng Chuan Group Pte. Ltd.
226.	Proposed Erection Of 2 Blocks Of 5 Storey Educational Building To The Existing International School On Lot 03643nMukim 19 At 2 Yishun Street 42.	Pre-Construction Condition Survey	14/04/2022	30/05/2022	Sunray Woodcraft Construction Pte. Ltd.
227.	Proposed Construction Works At 78 Chiselhurst Grove, Singapore 558661.	Pre-Construction Condition Survey	30/03/2022	09/06/2022	ML Prospec (SG) Pte. Ltd.
228.	Proposed Construction Works At 9 Jalan Lada Puteh, Singapore.	Pre-Construction Condition Survey	30/03/2022	13/06/2022	ML Prospec Development Pte. Ltd.
229.	Proposed Construction Works At 69a Coronation Road West, Singapore.	Pre-Construction Condition Survey	11/03/2022	11/04/2022	Lum Chang Building Contractors Pte. Ltd.
230.	Proposed Project At 355 Beach Road.	Pre-Construction Condition Survey	12/03/22	08/04/2022	Jai Chi Builders Pte. Ltd.
231.	Proposed Reconstruction Project At 26 Lichfield Road.	Pre-Construction Condition Survey	08/03/22	12/04/2022	Jai Chi Builders Pte. Ltd.

S/N	Project Title	Description of Works	Commencement Date	Completion Date	Client
232.	Proposed Reconstruction To Existing 3-Storey Semi-Detached Envelope Control Dwelling House On Lot 11454v Mk 18 At 55 Mimosa Walk (Serangoon Planning Area).	Pre-Construction Condition Survey	28/02/2022	18/03/2022	Optimus Developments Pte. Ltd.
233.	Proposed Erection Of A Block Of 8-Storey Residential Flats (Total 110 Units) With Communal Garden, Communal Facilities Including Swimming Pool At 3rd Storey, And Multi Storey Car Park From Lower 1st Storey To 2nd Storey On Lots 01717w, 01718v, 01719p, 01720w, 01721v, 97922n, 97921k, 97920a, 97919n, 97918k, 97917a, 97916t Mk 25 At House No. 31-51 (Odd) Lorong 24 Geylang (Geylang Planning Area).	Pre-Construction Condition Survey	22/12/2021	07/01/2022	Paul Y. Construction & Engineering Pte. Ltd.
234.	Proposed A New 3-Storey Office Building At No. 4 Gul Way, Singapore.	Pre-Construction Condition Survey	11/06/2021	26/07/2021	Nam Lee Pressed Metal Pte. Ltd.
235.	Proposed New Erection Of A 4-Storey Office Building On Lot 01317x Mk13 At No. 2a Woodlands Industrial Park D Singapore 737779.	Pre-Construction Condition Survey	25/05/2021	05/07/2021	Boustead Projects E&C Pte. Ltd.
236.	Proposed New Erection Of A 3-Storey Semi-Detached House With An Attic On Lot 05352l Mk28 At 20 Meragi Close.	Pre-Construction Condition Survey	07/05/2021	08/06/2021	B S Construction Services Pte. Ltd.
237.	Proposed Underpasses, Paths And At-Grade Crossings Along The Kallang Park Connector.	Pre-Construction Condition Survey	07/05/2021	23/06/2021	Samwoh Corporation Pte. Ltd.
238.	Proposed Contruction Works At 1 Fishery Port Road, Singapore 619729.	Pre-Construction Condition Survey	25/03/2021	10/05/2021	Leacon Engineering Pte. Ltd.
239.	Proposed Construction Works At No. 25 Tai Hwan Place, Singapore 555305.	Pre-Construction Condition Survey	17/03/2021	09/04/2021	i21 Builders Pte. Ltd.
240.	Proposed New Erection Of A 3 Storey Clubhouse For Singapore IsIresifaand Country Club (Sicc) And A&A To Existing Tennis Courts.	Pre-Construction Condition Survey	17/03/2021	26/04/2021	Sunray Woodcraft Construction Pte. Ltd.
241.	Proposed New Erection Of An Envelope Control 2 Storey With Attic Terrace Dwelling Unit At Mk18 Lot00997l At 10 Jalan Batai (Ang Mo Kio Planning Area).	Pre-Construction Condition Survey	02/02/2021	19/03/2021	Craftsmanship Pte. Ltd.

S/N	Project Title	Description of Works	Commencement Date	Completion Date	Client
242.	Proposed Construction Works At Maris Stella High School (Secondary), 25 Mount Vernon Road, Singapore.	Pre-Construction Condition Survey	04/02/2021	01/03/2021	Ryobi Geotechnique International Pte. Ltd.
243.	Refurbishment Works To Island Ballroom, Shangri-La Hotel.	Pre-Construction Condition Survey	26/01/2021	26/03/2021	Sunray Woodcraft Construction Pte. Ltd.
244.	Demolition Works At Lorong 6 Toa Payoh And Bedok North Street 3.	Pre-Construction Condition Survey	14/01/2021	01/03/2021	Peng Chuan Group Pte. Ltd.
245.	Proposed Building And Security Works At Currency House And Site B.	Pre-Construction Condition Survey	11/01/2021	06/04/2021	Wan Chung Construction (Singapore) Pte. Ltd.
246.	Proposed Construction Works At 24 Watten Close Singapore 287746.	Pre-Construction Condition Survey	08/01/2021	15/03/2021	Trace Design + Build Pte. Ltd.
247.	Proposed M&E Retrofitting Works To National Museum Of Singapore At 93 Stamford Road, Singapore 178897.	Pre-Construction Condition Survey	21/12/2020	24/02/2021	Shinryo Corporation
248.	Proposed New Erection Of 3 Blocks Of 5 Storey Residential Apartment (74 Units) With Basement Car Park, Swimming Pool And Communal Facilities On Lot 01493c Mk10 At Phoenix Road (Bukit Batok Planning Area).	Pre-Construction Condition Survey	08/01/2021	22/02/2021	ADB Foundation Pte. Ltd.
249.	Proposed Badminton Court, Hardcourt And Dog Run Facility Along Rifle Range Road (Under Anak Bukit Flyover) And Beside Mayfair Park.	Pre-Construction Condition Survey	20/11/2020	29/12/2020	Success Forever Construction & Maintenance Pte. Ltd.
250.	Proposed Construction At Tuas Link 4 Mk7 04967I Tol.	Pre-Construction Condition Survey	17/11/2020	17/12/2020	Precise Development Pte. Ltd.
251.	For Existing Showroom-Cum-Factory Building At 19 Leng Kee Road Singapore 159093.	Due Diligence Survey	06/11/2020	08/12/2020	Store Friendly Mgmt Pte. Ltd.
252.	Foodcourt And Retail Units (Level 1 & Level 2) At Centrium Square, 320 Serangoon Road, Singapore 218108.	Defect List Survey	11/09/2020	19/10/2020	Wilkinson International Pte. Ltd.
253.	Design And Built Of Temporary Dormitory – Phase 2 (Tengah : Parcel 2).	Pre-Construction Condition Survey	27/08/2020	09/09/2020	LC&T Builder (1971) Pte. Ltd.
254.	Proposed New Erection Of A 7 Storey Multi-User Light Industrial Building On Ts17 Lot 01243a At 17 Kallang Junction Singapore 339274.	Pre-Construction Condition Survey	17/08/2020	07/09/2020	Soilbuild Construction Group. Ltd.

S/N	Project Title	Description of Works	Commencement Date	Completion Date	Client
255.	Proposed Construction At 11 Lorong Pisang Asam.	Pre-Construction Condition Survey	03/08/2020	18/08/2020	Craftsmanship Pte. Ltd.
256.	Proposed Piperbridge And New Piping Service Corridor At Banyan Drive, Jurong Island.	Pre-Construction Condition Survey	19/07/2020	18/11/2020	WEC Engineers & Constructors Pte. Ltd.
257.	Proposed Erection Of 3 Storey Envelope Control Corner Terrace House With A Roof Terrace Mk On Lot 01923k 12 Lorong 7 Realty Park (Hougang Planning Area).	Pre-Construction Condition Survey	14/07/2020	30/07/2020	Jansen Sc International Pte. Ltd.
258.	Proposed 4-Storey Office, Workshop, Assembly Area & Warehouse For Gestetner Singapore Pte. Ltd. On Part Of Lot 1200, City District, Sub-Division No Xvii, Kallang Basin Industrial Estate, Boon Keng Road/ Kallang Junction, Singapore	Pre-Construction Condition Survey	22/06/2020	16/07/2020	Cheng Yap Construction Pte. Ltd.
259.	Proposed Mandai Rainforest Park South Comprising Themed Animal Habitats With Adventure And Play Elements, 1-Storey Wildlife Rehabilitation Centre, 1-Storey F&B Building, Aviary, Camping Facilities Elevated Walkway And Ancillary Facilities On Lot 01891m Mk14 At Mandai Lake Road (Central Water Catchment Planning Area).	Pre-Construction Condition Survey	17/03/2021	16/04/2021	China Jingye Engineering Corporation Limited
260.	Proposed Erection Of 2-Storey Envelope Control Semi-Detached Dwelling House With An Attic And Swimming Pool On Lot 99220M MK18 At 34 Ripley Crescent, Singapore 556212.	Pre-Construction Condition Survey	20/03/2020	03/04/2020	Kirpal & Associates
261.	Proposed Roadworks For Proposed Residential Development At Fourth Avenue (Bukit Timah Planning Area).	Pre-Construction Condition Survey	25/02/2020	6/04/2020	Eng Huat Heng Machinery Construction
262.	Demolition Of Show Flat At 51 Kampong Bugis.	Pre-Construction Condition Survey	24/02/2020	10/03/2020	Success Forever Construction & Maintenance Pte. Ltd.
263.	Proposed New Erection Of A 3-Storey Corner Terrace House At 8 Lor L Telok Kurau (Bedok Planning Area)	Pre-Construction Condition Survey	21/02/2020	30/03/2020	ZH Builders Pte. Ltd.
264.	Proposed A 4-Storey Single User Detached Factory At 22 Chin Bee Road (Boon Lay Planning Area).	Pre-Construction Condition Survey	17/02/2020	31/03/2020	Logistics Construction Pte. Ltd.

S/N	Project Title	Description of Works	Commencement Date	Completion Date	Client
265.	Proposed Reconstruction Of An Existing 2-Storey Terrace House At 30 Soo Chow Rise.	Pre-Construction Condition Survey	14/02/2020	10/03/2020	Craftsmanship Pte. Ltd.
266.	Proposed 3-Storey Terrace House At 7C Figaro Street (Bedok Planning Area).	Pre-Construction Condition Survey	03/02/2020	19/02/2020	YS Construction Services Pte. Ltd.
267.	Proposed A 3-Storey Semi-Detached House At 162 Carpmael Road (Marine Parade Planning Area).	Pre-Construction Condition Survey	21/01/2020	21/02/2020	Bellus Group Pte. Ltd.
268.	Proposed 2 Units Of 3-Storey Terrace Houses At 5&7 Florence Close.	Pre-Construction Condition Survey	16/01/2020	21/02/2020	Khian Heng Construction (Pte) Ltd.
269.	Demolition Work At 10 & 15 Hoe Chiang Road.	Pre-Construction Condition Survey	11/01/2020	23/03/2020	Beng Siew Construction Pte. Ltd.
270.	Proposed Development At Lot 79, Jalan Kemuning, Singapore.	Pre-Construction Condition Survey	10/01/2020	07/02/2020	ZH Builders Pte. Ltd.
271.	Proposed Reconstruction Of The Existing 3-Storey Detached House At 18 Fernhill Road.	Pre-Construction Condition Survey	03/01/2020	18/02/2020	QFC Construction Pte. Ltd.
272.	Proposed A 3-Storey Terrace House At 11 Jalan Kayu Manis.	Pre-Construction Condition Survey	31/12/2019	06/02/2020	Arsea Pte. Ltd.
273.	Proposed Demolition Of Mountbatten Community Club And Ancillary Structures At 35 Jalan Satu.	Post-Construction Condition Survey	24/12/2019	03/02/2020	Peng Chuan Engineering Construction Pte. Ltd.
274.	Proposed 3-Storey Terrace House At 5 Lorong Marzuki, Singapore 417043.	Pre-Construction Condition Survey	21/12/2019	27/01/2020	Trace Design + Build Pte. Ltd.
275.	Proposed 3-Storey Corner Terrace House On 148 Tagore Avenue.	Pre-Construction Condition Survey	27/11/2019	18/12/2019	Nan Guan Construction Pte. Ltd.
276.	HPB EOS Project Installation At 3, Second Hospital Ave, Singapore 168937.	Pre-Construction Condition Survey	22/11/2019	03/12/2019	Decormark Design Pte. Ltd.
277.	Replacement Of Contract For Proposed One Block Of 5-Storey Residential Flat Development (60 Units) At 5, Still Road (Marine Parade Planning Area).	Pre-Construction Condition Survey	12/11/2019	09/12/2019	He Zhan Construction Pte. Ltd.
278.	Proposed CT Scan Room (Medical Centre Building Level 4) At 5 Lower Kent Ridge Singapore 119074.	Pre-Construction Condition Survey	01/11/2019	18/11/2019	Decormark Design Pte. Ltd.
279.	Proposed A 6-Storey Factory And Distribution Complex At Tuas Link 2/3/4, Singapore.	Pre-Construction Condition Survey	30/10/2019	02/12/2019	Precise Development Pte. Ltd.

S/N	Project Title	Description of Works	Commencement Date	Completion Date	Client
280.	Proposed 3-Storey Single-User General Industrial Building At Kranji Road (Sungei Kadut Planning Area).	Pre-Construction Condition Survey	29/10/2019	18/11/2019	Sanwah Construction Pte. Ltd.
281.	Proposed Outline Application For An Erection Of A Pair Of 3-Storey Terrace And Corner Terrace House At 19e Charlton Lane (Housing Planning Area)	Pre-Construction Condition Survey	25/10/2019	25/11/2019	ML Prospec Development Pte. Ltd.
282.	Proposed A 7 Storey Industrial Building At 27 Kim Chuan Drive On Lot 06038P MK23.	Pre-Construction Condition Survey	24/10/2019	18/11/2019	Avergo Pte. Ltd.
283.	Proposed A 3-Storey Semi-Detached House At 5 Jalan Remis Singapore 468080.	Pre-Construction Condition Survey	23/10/2019	04/11/2019	Evergreen Renovation & Construction Pte. Ltd.
284.	Proposed A 3-Storey Semi-Detached House At 7 Sennett Avenue (Bedok Planning Area).	Pre-Construction Condition Survey	12/10/2019	04/11/2019	BHD Construction Pte Ltd
285.	Construction Of Covered Linkways, Drop Off Porches And Upgrading Of Communal Area (Batch 58) At Bishan – Toa Payoh Town Council Estates.	Pre-Construction Condition Survey	10/10/2019	26/11/2019	NU Systems Pte. Ltd.
286.	Surbanajurong Academy Proposed Interior Space Planning At 7, Adam Park, Adam Road.	Pre-Construction Condition Survey	05/10/2019	23/10/2019	Sunray Woodcraft Construction Pte. Ltd.
287.	Proposed Reconstruction Of A 2-Storey House To A 3-Storey House At 24 Hillview Drive (Bukit Batok Planning Area).	Pre-Construction Condition Survey	27/09/2019	09/10/2019	B S Construction Services Pte. Ltd.
288.	Provision Of Guaranteed Energy Savings Performance Contracting Services For Civil Service College.	Pre-Construction Condition Survey	27/09/2019	16/10/2019	D-Team Engineering Pte. Ltd.
289.	Proposed Linkways/ Covered Ramps/ Drop-Off Porch At Blk 27, 40, 43 Telok Blangah Way/ Rise.	Pre-Construction Condition Survey	25/09/2019	18/11/2019	NU Systems Pte. Ltd.
290.	Proposed Reconstruction Of A Detached House At No. 18 Rienzi Street.	Pre-Construction Condition Survey	14/09/2019	01/10/2019	Ace Builder Pte. Ltd.
291.	TTSH National Neuroscience Institute (NNI) Angiography Room.	Pre-Construction Condition Survey	13/09/2019	25/09/2019	Decormark Design Pte. Ltd.
292.	Proposed 2-Storey Semi-Detached House At 51A Gilstead Road (Novena Planning Area).	Pre-Construction Condition Survey	12/09/2019	10/10/2019	Bestec Construction Pte. Ltd.
293.	Proposed 10 Blocks Of Residential Flats & 1 Block Of Car Park At Edgedale Plains. (Punggol Planning Area).	Pre-Construction Condition Survey	07/09/2019	19/09/2019	Eng Chin Hang Plumbing & Sanitary Pte. Ltd.
294.	Proposed 9 Units Of 2-Storey Standard Factories At Seletar Aerospace Link.	Pre-Construction Condition Survey	02/09/2019	20/09/2019	Precise Development Pte. Ltd.

S/N	Project Title	Description of Works	Commencement Date	Completion Date	Client
295.	Proposed 19-Storey Hotel Development At Club Street.	Pre-Construction Condition Survey	29/08/2019	23/10/2019	Tiong Seng Contractors Pte. Ltd.
296.	Proposed Reconstruction Of An Existing 2-Storey Terrace House At Gardenia Road Singapore 578865 (Bishan Planning Area).	Pre-Construction Condition Survey	28/08/2019	13/09/2019	Craftsmanship Pte. Ltd.
297.	Proposed Demolition Of Mountbatten Community Club And Ancillary Structures At 35 Jalan Satu.	Pre-Construction Condition Survey	13/08/2019	30/08/2019	Peng Chuan Engineering Construction Pte. Ltd.
298.	Proposed 3-Storey Terrace House At Springwood Height.	Pre-Construction Condition Survey	08/08/2019	06/09/2019	YS Construction Services Pte. Ltd.
299.	Proposed Partial Demolition To An Existing 2-Storey Factory At 4 Pandan Crescent.	Pre-Construction Condition Survey	02/08/2019	11/09/2019	Precise Development Pte. Ltd.
300.	Proposed 4-Storey Factory With Ancillary Office At 9 Tuas Drive 1.	Pre-Construction Condition Survey	27/06/2019	10/07/2019	HPC Builders Pte. Ltd.
301.	Proposed A 4-Storey Factory Lot 02578M MK07 At 9 Tuas Drive 1 (Tuas Planning Area).	Pre-Construction Condition Survey	24/06/2019	10/07/2019	BHD Construction Pte. Ltd.